

## Ring Terminals

Constructed of electrolytic copper for high conductivity!

### Non-Insulated Ring Terminals

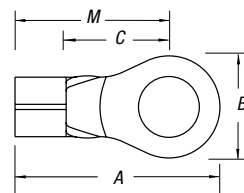

CAT. NO.	PKG. QTY.	WIRE RANGE	BOLT HOLE	REC. TOOL	DIMENSIONS				STOCK THICK.
					A	B	C	M	
A18-4	100	22-16	#4	ERG4002	.75	.31	.27	.59	.03
A18-6	100	22-16	#6		.72	.25	.27	.59	
A85	1,000	22-16	#6		.72	.25	.27	.59	
A18-8	100	22-16	#8		.75	.31	.27	.59	
A86	1,000	22-16	#8		.75	.31	.27	.59	
A18-10	100	22-16	#10		.75	.31	.27	.59	
A87	1,000	22-16	#10		.75	.31	.27	.59	
A18-14	100	22-16	1/4"		.92	.50	.37	.67	
A71	1,000	22-16	1/4"		.92	.50	.37	.67	
A18-516	100	22-16	5/16"		.92	.50	.37	.67	
A72	1,000	22-16	5/16"		.92	.50	.37	.67	
A18-38	100	22-16	3/8"		.99	.54	.35	.67	
A73	1,000	22-16	3/8"		.99	.54	.35	.67	
A18-12	100	22-16	1/2"		1.06	.72	.38	.70	
A75	1,000	22-16	1/2"		1.06	.72	.38	.70	
B14-4	100	18-14	#4	ERG4005	.72	.25	.27	.59	.03
B132	1,000	18-14	#4		.72	.25	.27	.59	
B14-6	100	18-14	#6		.72	.25	.27	.59	
B133	1,000	18-14	#6		.72	.25	.27	.59	
B14-8	100	18-14	#8		.75	.31	.27	.59	
B86	1,000	18-14	#8		.75	.31	.27	.59	
B14-10	100	18-14	#10		.75	.31	.27	.59	
B87	1,000	18-14	#10		.75	.31	.27	.59	
B14-14	100	18-14	1/4"		.93	.50	.38	.68	

Brazed Seam

CAT. NO.	PKG. QTY.	WIRE RANGE	BOLT HOLE	REC. TOOL	DIMENSIONS				STOCK THICK.	
					A	B	C	M		
B71	1,000	18-14	1/4"	ERG4002 ERG4005	.93	.50	.38	.68	.03	
B14-516	100	18-14	5/16"		.93	.50	.38	.68		
B72	1,000	18-14	5/16"		.93	.50	.38	.68		
B14-38	100	18-14	3/8"		.96	.54	.35	.68		
B73	1,000	18-14	3/8"		.96	.54	.35	.68		
B14-12	100	18-14	1/2"		1.06	.72	.38	.70		
B75-TB	1,000	18-14	1/2"		1.06	.72	.38	.70		
B85	1,000	18-14	#6		.75	.31	.27	.59		
B134	1,000	18-14	#8		.72	.25	.27	.59		
C10-6-SK	50	12-10	#6		.82	.31	.27	.66		.04
C33	500	12-10	#6		.82	.31	.27	.66		
C10-8-SK	50	12-10	#8		.82	.31	.27	.66		
C77	500	12-10	#8		.82	.31	.27	.66		
C10-10	50	12-10	#10		.85	.38	.27	.66		
C26	500	12-10	#10		.85	.38	.27	.66		
C36	500	12-10	#10	.82	.31	.27	.66			
C10-14	50	12-10	1/4"	.91	.50	.27	.66			
C71	500	12-10	1/4"	.91	.50	.27	.66			
C10-516	50	12-10	5/16"	.98	.50	.38	.73			
C70	500	12-10	5/16"	.98	.50	.38	.73			
C72	500	12-10	3/8"	1.10	.59	.45	.80			
C10-38	50	12-10	3/8"	1.10	.59	.45	.80			
C73	500	12-10	3/8"	1.10	.59	.45	.80			
C10-12	50	12-10	1/2"	1.21	.72	.38	.84			
C75	500	12-10	1/2"	1.21	.72	.38	.84			

## Wire Termination Technical Information

Note: All catalog numbers do not appear in this cross reference. This means it may not be available in one of the package options.

CAT. NO. T&B DISTRIBUTOR PACKAGE	CAT. NO. T&B BULK PACKAGE	CAT. NO. T&B DISTRIBUTOR PACKAGE	CAT. NO. T&B BULK PACKAGE	CAT. NO. T&B DISTRIBUTOR PACKAGE	CAT. NO. T&B BULK PACKAGE	CAT. NO. T&B DISTRIBUTOR PACKAGE	CAT. NO. T&B BULK PACKAGE
10RC-10	RC367	14RBD-183	RBD1837	A18-10	A87	B14-8FL	B223
10RC-10F	RC1157	14RBD-18377	RBD18377	A18-10F	A115-TB	B14-D	B23
10RC-10FL	RC2227	18RA-10	RA877	A18-10FL	A225	BC14-10	BC87
10RC-10FLX	RC2227-250	18RA-10F	RA1157	A18-110F	A10-TB	BC14-12	BC75
10RC-10FX	RC1157-250	18RA-10FL	RA2257	A18-111F	A11	BC14-14	BC71
10RC-10X	RC367-250	18RA-10FLX	RA2257-170	A18-12	A75	BC14-38	BC79
10RC-14	RC717	18RA-10X	RA877-170	A18-14	A71	BC14-516	BC72
10RC-14F	RC1167	18RA-14	RA717	A18-250	A250-TB	BC14-6	BC85
10RC-14FL	RC2237	18RA-250F	RA257	18RA-6FLX	RA2217-170	BC14-8	BC86
10RC-14X	RC717-250	18RA-250T	RA2517	18RA-6FX	RA1167-170	BD14-183	BD183
10RC-250F	RC257	18RA-251T	RA25177	18RA-6X	RA857-170	C10-10	C26
10RC-250T	RC2517	18RA-2577	RA2573	18RA-8	RA867	C10-10A	C53
10RC-251T	RC25177	18RA-38	RA737	18RA-8F	RA1147	C10-10F	C115
10RC-2577	RC2573	18RA-4	RA77	18RA-8FL	RA2247	C10-10FL	C222-TB
10RC-38	RC737	18RA-47PT	RA47PT	18RA-8FX	RA1147-170	C10-12	C75
10RC-38X	RC737-250	18RA-516	RA727	18RA-8X	RA867-170	C10-14	C71
10RC-516	RC707	18RA-516X	RA727-170	18RAD-182	RAD1827	BC14-10	BC87
10RC-55PT	RC55PT	18RA-6	RA857	18RAD-18277	RAD18277	BC14-14	BC71
10RC-6	RC337	18RA-6F	RA1167	18RAD-183	RAD1837	BC14-38	BC79
10RC-6F	RC1337	18RA-6FL	RA2217	18RAD-18377	RAD18377	BC14-516	BC72
10RC-6FL	RC2207	18RA-6FLX	RA2217-170	2A-18	AA2	BC14-6	BC85
10RC-6FLX	RC2207-250	18RA-6FX	RA1167-170	2A-18	AA2	BC14-8	BC86
10RC-6X	RC337-250	18RA-6X	RA857-170	2A20	RAA24	BD14-183	BD183
10RC-8	RC777	18RA-8	RA867	2A22-20	A1A	C10-10	C26
10RC-8F	RC1147	18RA-8F	RA1147	2B-14	BB2	C10-10A	C53
10RC-8FL	RC2217	18RA-8FL	RA2247	2B-16	RBB25	C10-10F	C115
10RC-8FLX	RC2217-250	18RA-8FX	RA1147-170	2B18-16	B1B	C10-10FL	C222-TB
10RC-8X	RC777-250	18RA-8X	RA867-170	2C-10	CC2-TB	C10-12	C75
14RB-10	RB877	18RAD-182	RAD1827	2C-12	RCC26	C10-14	C71
14RB-10F	RB1157	18RAD-18277	RAD18277	A18-250A	A252G	C10-14F	C116-TB
14RB-10FL	RB2257	18RAD-183	RAD1837	A18-251T	A251	C10-250A	C252G
14RB-10FLX	RB2257-200	18RAD-18377	RAD18377	A18-38	A73	C10-250F	C250
14RB-10FX	RB1157-200	2A-18	AA2	A18-516	A72	C10-38	C73
14RB-10X	RB877-200	2A-18	AA2	A18-6	A85	C10-516	C70
14RB-14	RB717	2A20	RAA24	A18-6F	A116	C10-6F	C133
14RB-14F	RB1717	2A22-20	A1A	A18-6FL	A221	C10-6FL	C220-TB
14RB-14X	RB717-200	2B-14	BB2	A18-8	A86	C10-6-SK	C33
14RB-250F	RB257	2B-16	RBB25	A18-8F	A114	C10-8A	C52-TB
14RB-250T	RB2517	2B18-16	B1B	A18-8FL	A224	C10-8F	C114
14RB-251T	RB25177	2C-10	CC2-TB	AB14-10A	AB53	C10-8FL	C221
14RB-2577	RB2573	2C-12	RCC26	AB14-6A	AB51	C10-8-SK	C77
14RB-38	RB737	2C14-12	C1C	AB14-8A	AB52	D8-10	D36
14RB-4	RB1327	2D10-9	D1D	AD18-182	AD182	D8-12	D75
14RB-47PT	RB47PT	2D-8	DD102	AD18-183	AD183	D8-14-SK	D71
14RB-516	RB727	2E-6	EE2	B14-10	B87	D8-38	D73
14RB-6	RB857	2E8-7	E1E	B14-10F	B115	D8-516	D72
14RB-6F	RB647	2F-4	FF2	B14-10FL	B225	E6-10	E26
14RB-6FL	RB2207	2F6-5	F1F	B14-10G	B87G	E6-12	E75
14RB-6FLX	RB2207-200	2G21	GG2	B14-110F	B10TB	E6-14	E71
14RB-6FX	RB647-200	2G4-2	G1G	B14-111F	B11-TB	E6-12	E75
14RB-6X	RB857-200	2RA18	RAA21	B14-12	B75TB	E6-14	E71
14RB-8	RB867	2RA18X	RAA217-170	B14-14	B71	E6-38	E73
14RB-8F	RB657	2RAA	RAA23	B14-250	B250	E6-516	E72
14RB-8FL	RB2237	2RAS18X	RAAS22X	B14-250A	B252G	F250TA	FTA250
14RB-8FLX	RB2237-200	2RB14	RBB21	B14-250F	B250G	F4-10	F26
14RB-8FX	RB657-200	2RB14X	RBB217-200	B14-250T	B251G	F4-12	F75
14RB-8X	RB867-200	2RBB	RBB23	B14-251T	B251	F4-14	F71-TB
14RBC-10	RBC877	2RBS14X	RBBS22X	B14-38	B73	F4-38	F73
14RBC-12	RBC757	2RC10	RCC21	B14-4	B132	F4-516	F72
14RBC-14	RBC717	2RC10X	RCC217-250	B14-516	B72	G2-12	G975
14RBC-38	RBC797	2RCC	RCC23	B14-6	B133	G2-14	G971
14RBC-516	RBC727	2RCS10X	RCCS22X	B14-6F	B64	G2-38	G973
14RBC-6	RBC857	2RD8	RDD27	B14-6FL	B220	G2-516	G972
14RBD-182	RBD1827	2RE6	REE28	B14-8	B86	H10-14	H971
14RBD-18277	RBD18277	2RZZ	RZZ23	B14-8F	B65TB	J20-38	J973

Wire Termination — Sta-Kon® Wire Termination & Insulation

## Wire Termination Technical Information

CAT. NO. T&B DISTRIBUTOR PACKAGE	CAT. NO. T&B BULK PACKAGE
K30-38	K973
L40-38	L973
M250-38	M973
NW14-10	NW83
NW14-12	NW84
NW22-10	NW23
RA18-10	RA873
RA18-10F	RA1153
RA18-10FL	RA2253
RA18-10FS	RA1253
RA18-110F	RA10SK
RA18-111F	RA11
RA18-12	RA753
RA18-14	RA713
RA18-14F	RA1163
RA18-250A	RA2577F
RA18-250F	RA250TB
RA18-250FP	RA250P
RA18-38	RA733
RA18-4	RA323
RA18-47PT	RA147PT
RA18-516	RA723
RA18-6	RA853
RA18-6F	RA1103
RA18-6FL	RA2213
RA18-6FS	RA1203
RA18-8	RA863
RA18-8F	RA1123
RA18-8FL	RA2243
RA18-8FS	RA1223
RA18D	RA23
RAD18-182	RAD1823
RAD18-183	RAD1833
RAD18-188A	RAD1887F
RB4-HT	RB44-HT
RB14-10	RB873
RB14-10F	RB1153
RB14-10FL	RB2253
RB14-10FS	RB1253
RB14-10X	RB874
RB14-110F	RB10-SK
RB14-111F	RB11-TB
RB14-12	RB753
RB14-14	RB713
RB14-14F	RB1163
RB14-14X	RB714
RB14-250	RBB250
RB14-250A	RB2577F
RB14-250F	RB250
RB14-250FP	RB250P
RB14-38	RB733
RB14-38X	RB734
RB14-4	RB1323
RB14-47PT	RB147PT
RB14-516	RB723
RB14-516X	RB724
RB14-6	RB853
RB14-38	RB733
RB14-38X	RB734
RB14-4	RB1323
RB14-47PT	RB147PT
RB14-516	RB723
RB14-516X	RB724
RB14-6	RB853
RB14-6F	RB1113

CAT. NO. T&B DISTRIBUTOR PACKAGE	CAT. NO. T&B BULK PACKAGE
RB14-6F	RB1113
RB14-6FL	RB2213
RB14-6FS	RB1203
RB14-6X	RB854
RB14-8	RB863
RB14-8F	RB1123
RB14-8FL	RB2233
RB14-8FS	RB1223
RB14-8X	RB864
RB14D	RB23
RB44	RB4-TB
RBC14-12	RBC753
RBC14-14	RBC713
RBC14-8	RBC863
RBD14-182	RBD1823
RBD14-183	RBD1833
RC6-T	RC551-HT
RC10-10	RC363
RC10-10F	RC1153
RC10-10FL	RC2223
RC10-10FS	RC1253
RC10-10X	RC364
RC10-12	RC753
RC10-14	RC713
RC10-14F	RC1163
RC10-14FL	RC2233
RC10-14X	RC714
RC10-250A	RC2577F
RC10-250F	RC250
RC10-38	RC733
RC10-38X	RC734
RC10-516	RC703
RC10-516X	RC704
RC10-55PT	RC155PT
RC10-6	RC333
RC10-6F	RC1113
RC10-6FL	RC2203
RC10-6X	RC334
RC10-8	RC863
RC10-8F	RC1123
RC10-8FL	RC2213
RC10-8FS	RC1223
RC10-8X	RC864
RC55	RC6
RD8-10	RD367
RD8-12	RD757
RD8-14	RD717
RD8-38	RD737
RD8-516	RD727
RE6-10	RE267
RE6-12	RE757
RE6-14	RE717
RE6-38	RE737
RE6-516	RE727
RF4-10	RF267
RF4-14	RF717
RF4-38	RF737
RF4-516	RF727
RG2-10	RG267
RG2-12	RG757
RG2-14	RG717
RG2-38	RG737
RG2-516	RG727
RP7-T	RP12-HT
RP12	RP7

CAT. NO. T&B BULK PACKAGE	CAT. NO. T&B DISTRIBUTOR PACKAGE
A10-TB	A18-110F
A11	A18-111F
A114	A18-8F
A115-TB	A18-10F
A116	A18-6F
A1A	2A22-20
A221	A18-6FL
A224	A18-8FL
A225	A18-10FL
A250-TB	A18-250
A251	A18-251T
A252G	A18-250A
A71	A18-14
A72	A18-516
A73	A18-38
A75	A18-12
A85	A18-6
A86	A18-8
A87	A18-10
AA2	2A-18
AB51	AB14-6A
AB52	AB14-8A
AB53	AB14-10A
AD182	AD18-182
AD183	AD18-183
B10TB	B14-110F
B115	B14-10F
B11-TB	B14-111F
B132	B14-4
B133	B14-6
B1B	2B18-16
B220	B14-6FL
B223	B14-8FL
B225	B14-10FL
B23	B14-D
B250	B14-250
B250G	B14-250F
B251	B14-251T
B251G	B14-250T
B252G	B14-250A
B64	B14-6F
B65TB	B14-8F
B71	B14-14
B72	B14-516
B73	B14-38
B75TB	B14-12
B86	B14-8
B87	B14-10
B87	B14-10
B87G	B14-10G
BB2	2B-14
BC71	BC14-14
BC72	BC14-516
BC75	BC14-12
BC79	BC14-38
BC85	BC14-6
BC86	BC14-8
BC87	BC14-10
BD183	BD14-183
C114	C10-8F
C115	C10-10F
C116-TB	C10-14F
C133	C10-6F
C1C	2C14-12
C220-TB	C10-6FL

CAT. NO. T&B BULK PACKAGE	CAT. NO. T&B DISTRIBUTOR PACKAGE
C221	C10-8FL
C222-TB	C10-10FL
C250	C10-250F
C252G	C10-250A
C26	C10-10
C33	C10-6-SK
C52-TB	C10-8A
C53	C10-10A
C70	C10-516
C71	C10-14
C73	C10-38
C75	C10-12
C77	C10-8-SK
CC2-TB	2C-10
D1D	2D10-9
D36	D8-10
D71	D8-14-SK
D72	D8-516
D73	D8-38
D75	D8-12
DD102	2D-8
E1E	2E8-7
E26	E6-10
E71	E6-14
E72	E6-516
E73	E6-38
E75	E6-12
EE2	2E-6
F1F	2F6-5
F26	F4-10
F71-TB	F4-14
F72	F4-516
F73	F4-38
F75	F4-12
FF2	2F-4
FTA250	F250TA
G1G	2G4-2
G971	G2-14
G972	G2-516
G973	G2-38
G975	G2-12
GG2	2G21
H971	H10-14
J973	J20-38
K973	K30-38
L973	L40-38
M973	M250-38
NW23	NW22-10
NW83	NW14-10
NW84	NW14-12
RA1153	RA18-10F
RA1157	18RA-10F
RA1163	RA18-14F
RA1167	18RA-6F
RA1167-170	18RA-6FX
RA1203	RA18-6FS
RA1223	RA18-8FS
RA1253	RA18-10FS
RA147PT	RA18-47PT
RA2213	RA18-6FL
RA2217	18RA-6FL
RA2217-170	18RA-6FLX
RA2243	RA18-8FL
RA2247	18RA-8FL
RA2253	RA18-10FL