

Fork Terminals

- Fork terminals enable easy installation because the mounting screw does not have to be completely removed
- Brazed-seam barrel is serrated for high pull-out value. Terminal is high-conductivity electrolytic copper, electro-tin plated.
- Insulation is color coded
- Vinyl-insulated fork terminals have extra-long PVC insulation sleeve for protection and stress relief at wire's flex point
- Suffix "X" indicates an expanded insulation support, meaning a wider wire entry to accommodate heavy wall insulation

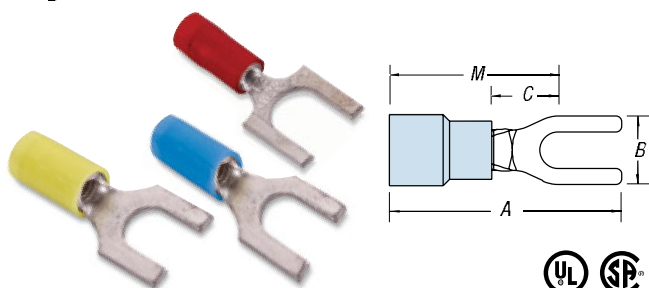

Nylon-Insulated Forks



CAT. NO.	PKG. QTY.	WIRE RANGE	MAX. INS.	BOLT HOLE	REC. TOOL	DIMENSIONS				STOCK THICK.
						A	B	C	M	
RA18-6F	100	22-16	.136	#6		.83	.25	.25	.71	.02
RA1103	1,000	22-16	.136	#6		.83	.25	.25	.71	
RA18-8F	100	22-16	.136	#8		.86	.31	.25	.71	
RA1123	1,000	22-16	.136	#8		.86	.31	.25	.71	
RA18-10F	100	22-16	.136	#10		.86	.31	.25	.71	
RA1153	1,000	22-16	.136	#10		.86	.31	.25	.71	
RA18-14F	100	22-16	.136	1/4"		.95	.44	.31	.70	.03
RA1163	1,000	22-16	.136	1/4"		.95	.44	.31	.70	
RB14-6F	100	18-14	.162	#6		.87	.31	.25	.71	
RB1113	1,000	18-14	.162	#6		.87	.31	.25	.71	
RB14-8F	100	18-14	.162	#8		.87	.31	.25	.71	
RB1123	1,000	18-14	.162	#8		.87	.31	.25	.71	
RB14-10F	100	18-14	.162	#10		.87	.38	.25	.71	.04
RB1153	1,000	18-14	.162	#10		.87	.38	.25	.71	
RB14-14F	100	18-14	.162	1/4"	ERG4001	.95	.44	.28	.74	
RB1163	1,000	18-14	.162	1/4"		.95	.44	.28	.74	
RB1103	1,000	18-14	.162	#6		.74	.28	.16	.60	
RB1124	1,000	18-14	.190	#8		.95	.31	.25	.79	
RB1154	1,000	18-14	.190	#10		.95	.31	.25	.79	
RC10-6F	50	12-10	.210	#6		.97	.31	.27	.81	.04
RC1113	500	12-10	.210	#6		.97	.31	.27	.81	
RC10-8F	50	12-10	.210	#8		1.00	.37	.27	.81	
RC1123	500	12-10	.210	#8		1.00	.37	.27	.81	
RC10-10F	50	12-10	.210	#10		1.00	.37	.27	.81	
RC1153	500	12-10	.210	#10		1.00	.37	.27	.81	
RC10-14F	50	12-10	.210	1/4"		1.12	.50	.27	.86	
RC1163	500	12-10	.210	1/4"		1.12	.50	.27	.86	
RC1124	1,000	12-10	.250	#8		1.10	.37	.27	.91	
RC1154	1,000	12-10	.250	#10		1.10	.37	.27	.91	

Nylon-Insulated Locking Forks

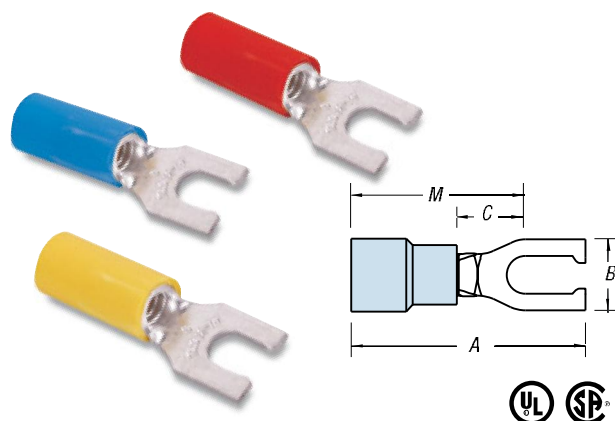

CAT. NO.	PKG. QTY.	WIRE RANGE	MAX. INS.	BOLT HOLE	REC. TOOL	DIMENSIONS				STOCK THICK.
						A	B	C	M	
RA18-6FL	100	22-16	.136	#6		.86	.25	.25	.71	.02
RA2213	1,000	22-16	.136	#6		.86	.25	.25	.71	
RA18-8FL	100	22-16	.136	#8		.86	.29	.25	.71	
RA2243	1,000	22-16	.136	#8		.86	.29	.25	.71	
RA18-10FL	100	22-16	.136	#10		.86	.29	.25	.71	
RA2253	1,000	22-16	.136	#10		.86	.29	.25	.71	
RB14-6FL	100	18-14	.162	#6		.87	.25	.25	.71	.03
RB2213	1,000	18-14	.162	#6		.87	.25	.25	.71	
RB2214	1,000	18-14	.190	#6		.95	.25	.25	.79	
RB14-8FL	100	18-14	.162	#8		.87	.29	.25	.71	
RB2233	1,000	18-14	.162	#8		.87	.29	.25	.71	
RB14-10FL	100	18-14	.162	#10		.87	.29	.25	.71	
RB2253	1,000	18-14	.162	#10		.87	.29	.25	.71	
RB2254	1,000	18-14	.190	#10		.95	.29	.25	.71	
RC10-6FL	50	12-10	.210	#6		.97	.31	.27	.81	.04
RC2203	500	12-10	.210	#6		.97	.31	.27	.81	
RC2204	1,000	12-10	.250	#6		1.07	.31	.27	.91	
RC10-8FL	50	12-10	.210	#8		1.00	.37	.27	.81	
RC2213	500	12-10	.210	#8		1.00	.37	.27	.81	
RC10-10FL	50	12-10	.210	#10		1.00	.37	.27	.81	
RC2223	500	12-10	.210	#10		1.00	.37	.27	.81	
RC2224	1,000	12-10	.250	#10		1.10	.37	.27	.91	
RC10-14FL	50	12-10	.210	1/4"		1.12	.50	.32	.86	
RC2233	500	12-10	.210	1/4"		1.12	.50	.32	.86	

Fork Terminals and Pin Terminals

Non-Insulated Locking Fork Terminals

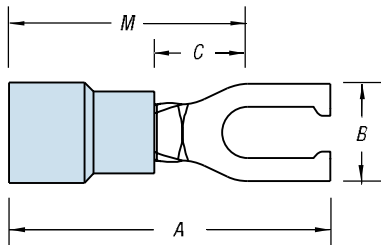

CAT. NO.	PKG. QTY.	WIRE RANGE	BOLT HOLE	REC. TOOL	DIMENSIONS				STOCK THICK.	
					A	B	C	M		
A18-6FL	100	22-16	#6	ERG4002	.75	.25	.27	.59	.02	
A221	1,000	22-16	#6		.75	.25	.27	.59		
A18-8FL	100	22-16	#8		.75	.29	.27	.59		
A224	1,000	22-16	#8		.75	.29	.27	.59		
A18-10FL	100	22-16	#10		.75	.29	.27	.59		
A225	1,000	22-16	#10		.75	.29	.27	.59		
B14-6FL	100	18-14	#6	ERG4002 ERG4005	.75	.25	.27	.59	.03	
B220	1,000	18-14	#6		.75	.25	.27	.59		
B14-8FL	100	18-14	#8		.75	.29	.27	.59		
B223	1,000	18-14	#8		.75	.29	.27	.59		
B14-10FL	100	18-14	#10		.75	.29	.27	.59		
B225	1,000	18-14	#10		.75	.29	.27	.59		
C10-6FL	50	12-10	#6		.85	.31	.27	.66		.04
C220-TB	500	12-10	#6		.85	.31	.27	.66		
C10-8FL	50	12-10	#8	.85	.37	.27	.66			
C221	500	12-10	#8	.85	.37	.27	.66			
C10-10FL	50	12-10	#10	.85	.37	.27	.66			
C222	500	12-10	#10	.85	.37	.27	.66			
C10-14FL	50	12-10	1/4"	.85	.49	.27	.66			

Pin Terminals

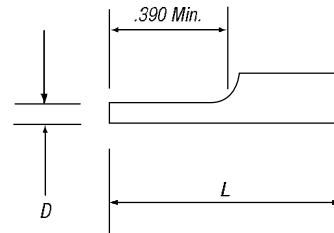

Non-Insulated Pin Terminal

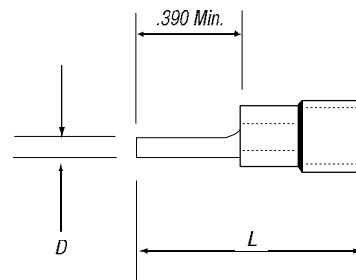

Insulated Pin Terminal



CAT. NO.	PKG. QTY.	WIRE RANGE	D (DIA.)	L	REC. TOOLS	STOCK THICK.
Non-Insulated						
A47PT	1,000	22-18	.075	.63	ERG4002	.02
B47PT	1,000	16-14	.075	.63		.03
C55PT	500	12-10	.106	.76		.04
Vinyl						
18RA-47PT	100	22-18	.075	.85	ERG4001	.02
RA47PT	1,000	22-18	.075	.85		.03
14RB-47PT	100	16-14	.075	.87		
RB47PT	1,000	16-14	.075	.87		.04
10RC-55PT	50	12-10	.106	1.04	.04	
RC55PT	500	12-10	.106	1.04		
Nylon						
RA18-47PT	100	22-18	.075	.85	ERG4001	.02
RA147PT	1,000	22-18	.075	.85		.03
RB14-47PT	100	16-14	.075	.87		
RB147PT	1,000	16-14	.075	.87		.04
RC10-55PT	50	12-10	.106	1.04	.04	
RC155PT	500	12-10	.106	1.04		

Wire Termination — Sta-Kon® Wire Termination & Insulation