

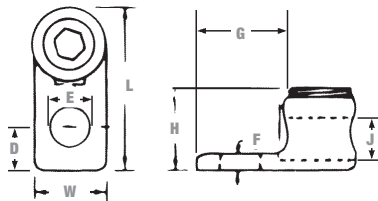

## Copper Mechanical Connectors

### Type L — Single Conductor, One-Hole Mount

- For copper conductors
- Screws are plated steel
- Compact design
- Add suffix P to catalogue number for tin plating
- One-piece construction for strength and durability
- Excellent for confined quarters
- Cat. Nos. L400 and L650 are cast from high strength bronze alloy
- Cat. Nos. L35, L70, L125 and L250 are cold forged from pure electrolytic copper
- Other models are cast from high strength bronze alloy
- CSA Certified and UL Listed



Cat. No.		Conductor Range		Dimensions (in.)							
Socket	Hex	Max.	Min.	L	W	H	F	D	J	E	G
L35*	-	8 str.	14 sol.	13/16	3/8	3/8	3/32	13/64	11/64	13/64	1/2
L70*	-	4 str.		1-1/8	17/32	35/64		9/32	9/32	9/32	21/32
L125BB**	L125H	1/0 str.	8 sol.	1-1/2	47/64	3/4		3/8	27/64	21/64	27/32
L250**	L250H	250 kcmil	6 str.	1-61/64	15/16	1-1/16	1/8	29/64	5/8	13/32	1-3/32
L400-BB**	L400H	500 kcmil	4/0 str.	3	1-13/32	1-15/32	9/32	5/8	7/8	9/16	1-5/8
L650BB**	L650H	1000 kcmil	500 kcmil	4	2	2-3/16	17/32	3/4	1-1/4		2

\* Sizes L35 and L70 have screwdriver slot head screws only.  
 \*\* Sizes L125 and up are Allen head screws.

### Type L — Single Conductor, Two-Hole Mount

- Cast from high strength bronze alloy
- For use where large contact area is required to provide a more secure mounting
- CSA Certified and UL Listed

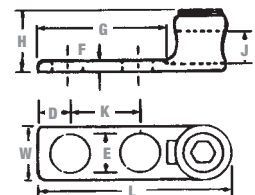
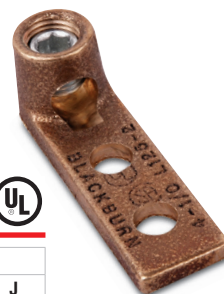

Cat. No.		Conductor Range		Dimensions (in.)									
Socket	Hex	Max.	Min.	L	W	H	F	D	K	E	G	J	
L1252	L1252H	1/0 str.	4 str.	2-13/16	25/32	13/16	3/16			11/32	2	27/64	
L2502	L2502H	250 kcmil	1/0 str.	3	3	1-1/32	15/64	7/16	1	13/32	1-7/8	5/8	
L4002	L4002H	500 kcmil	4/0 str.	3-3/8	3-3/8	1-15/32	5/16			1-15/16	57/64		
L6502-BB	L6502H	1000 kcmil	500 kcmil	4-15/16	4-15/16	2	3/8	9/16	1-1/2	9/16	2-3/4	1-1/4	

## Competitive Cross Reference

Types L — Copper Mechanical Connectors, Single Conductor, One-Hole Mount							
Blackburn®	Penn Union	Burndy	IlSCO/Utilco	T&B®	Anderson	Dossert	Gedney
L35	PNL-8	KA8C	SLU-35	31003	LU-08	D-35	SL081
L70	PNL-4	KA4C	SLU-70	31005	LU-04	D-70	SL041
L125	PNL-1/0	KA25	LO-0	31007	LU-1/0	D-10	SL211
L250	PNL-250	KA28	LO-250	31011	—	D-25	SL241
L400	PNL-500	KA34	LO-500	31015	LU-500	D-50	SL501
L650	PNL-1000	QA44B	LO-1000	31019	LU-1000	D-100	SL921
Types L — Copper Mechanical Connectors, Single Conductor, Two-Hole Mount							
Blackburn®	Penn Union	Burndy	IlSCO/Utilco	T&B®	Anderson	Dossert	Gedney
L1252	PNL-1/0-2	QA1C-2B	E-125	32007	—	—	SL212
L2502	PNL-250-2	QA28-2B	E-225	32011			SL242
L4002	PNL-500-2	QA35-2B	E-400	32015			S1502
L6502	PNL-1000-2	QA44-2B	E-650	32019			SL922
Types TL — Copper Mechanical Connectors, Two Conductors, Two-Hole Mount							
Blackburn®	Penn Union	Burndy	IlSCO/Utilco	T&B®	Anderson	Dossert	Gedney
TL250	—	Q2A31-2N	LU-4	32013BD	—	D2-25	SLL302
TL400	SLL504	Q2A34-2N	—	32015BD	LU2-500-2N	D2-50	SLL504
TL650	—	Q2A44-2N	—	32019BD	—	D2-100	SLL924
Type STC — Copper Single Conductor, One-Hole Mount, Straight Tang							
Blackburn®	Penn Union	Burndy	IlSCO/Utilco	T&B®	Anderson	Dossert	Gedney
STC1014	—	—	SLS25	—	—	—	—
STC0614		KPA8CUP	SLS35				
STC0414		KPA4CUP	SAS70				
STC0208		—	SLS70				
STC1102		KPA25UP	SLS125				
STC3104		—	SLS175				
STC4102		KPA28UP	SLS225				
STC3511		—	SLS300				
STC5011		KPA34UP	SLS400				
STC9960		—	SLS650				
Type BTC — Copper Single Conductor, One-Hole Mount, Offset Tang							
Blackburn®	Penn Union	Burndy	IlSCO/Utilco	T&B®	Anderson	Dossert	Gedney
BTC1014	SLU-25	—	SLU-25	—	—	—	—
BTC0614	SLU-35	KPA8C	SLU-35			G-35-1	
BTC0208	SLU-70	KPA4C	SLU-70			G-70-1	
BTC1102	SLU-125	KPA25	SLU-125			G-125-1	
BTC3104	SLU-175	—	SLU-175			—	
BTC4102	SLU-225	KPA28	SLU-225			G-225-1	
BTC3511	SLU-300	—	SLU-300			—	
BTC5011	SLU-400	KPA34	SLU-400			G-400-1	
BTC9960	SLU-650	—	SLU-650			G-650-1	