

### TYPE KVS

#### OKLIP™

Copper & Copperweld

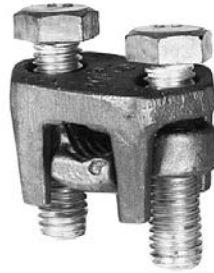

Compact, two-piece, high strength, high copper alloy BURNDY® OKLIP™ recommended for heavy duty connections. Neoprene rings hold DURIMUM™ silicon bronze bolts in place during installation. Installed with ordinary wrench.

| Catalog Number | Conductor           |                       |               |       |        | Recommended Tightening Torque (in-lb) |
|----------------|---------------------|-----------------------|---------------|-------|--------|---------------------------------------|
|                | Copper              |                       | Copperweld    |       |        |                                       |
|                | Run                 | Tap                   | Max Run & Tap |       |        |                                       |
|                |                     |                       | Sol.          | Str.  | Type V |                                       |
| <b>KVS26</b>   | 2 Str. - 2/0 Str.   | 6 Str. - 2/0 Str.     | 3/0           | 7 #8  | —      | 180                                   |
| <b>KVS28</b>   | 1/0 Str. - 4/0 Str. | 10 Str. - 4/0 Str.    | 4/0           | 7 #6  | V3/0   | 250                                   |
| <b>KVS31</b>   | 250 - 350 kcmil     | 10 Str. - 350 kcmil   | —             | 19 #8 | V250   | 325                                   |
| <b>KVS34</b>   | 400 - 500 kcmil     | 10 Str. - 500 kcmil   | —             | 19 #6 | V350   | 375                                   |
| <b>KVS40</b>   | 400 - 800 kcmil     | 3/0 Str. - 800 kcmil  | —             | 19 #5 | —      | 500                                   |
| <b>KVS44</b>   | 500 - 1000 kcmil    | 3/0 Str. - 1000 kcmil | —             | —     | —      | 500                                   |

▲ Listed torque values are for maximum conductor combinations accommodated. Consult UL486 Tables 7-4, 7-5, 7-6 for smaller conductor combinations.  
 ✓ See note LIGHTNING PROTECTION INFO.

### TYPE KVSU

#### UNIVERSAL OKLIP™

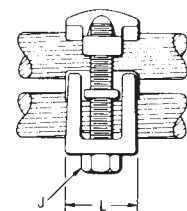
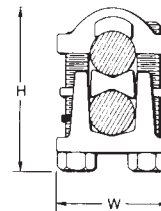

Mechanical Connector All Combinations of Copper, Aluminum, ACSR, AAAC & 5005

Compact, high strength, tin plated copper alloy two-piece connector with spacer and tin-plated silicon bronze DURIMUM™ hardware. Recommended for heavy duty connections. Spacer separates

dissimilar conductors and provides long contact length. Neoprene ring prevents loss of shorter bolt during installation. Longer peened bolt

permits swivel action for easier installation. Use of PENETROX™ joint compound recommended with aluminum and ACSR.

| Catalog Number | Conductor           |                    |                   |                    |                              |                 |                              |                 | H     | J    | L     | W     | Rec. Tightening Torque (in-lb) |
|----------------|---------------------|--------------------|-------------------|--------------------|------------------------------|-----------------|------------------------------|-----------------|-------|------|-------|-------|--------------------------------|
|                | Run                 |                    | Tap               |                    | Run                          |                 | Tap                          |                 |       |      |       |       |                                |
|                | Copper & Alum       | ACSR, AAAC, & 5005 | Copper & Alum     | ACSR, AAAC, & 5005 | Copper Sol., Copperweld Sol. | Steel Nom. Dia. | Copper Sol., Copperweld Sol. | Steel Nom. Dia. |       |      |       |       |                                |
| <b>KVSU26</b>  | 2 Str. - 2/0 Str.   | 3 - 2/0            | 6 Str. - 2/0 Str. | 6 - 2/0            | 1 - 3/0                      | 5/16 - 7/16     | #6 - 3/0                     | 3/16 - 7/16     | 2     | 5/16 | 1     | 1-1/2 | 180                            |
| <b>KVSU28</b>  | 1/0 Str. - 4/0 Str. | 1/0 - 4/0          | 6 Str. - 4/0 Str. | 6 - 4/0            | 2/0 - 4/0                    | 3/8 - 1/2       | #6 - 4/0                     | 5/32 - 1/2      | 2-3/8 | 3/8  | 1-1/8 | 1-3/4 | 250                            |
| <b>KVSU31</b>  | 250 - 350 kcmil     | 4/0 - 300          | #6 - 350          | 6 - 300            | -                            | 9/16 - 5/8      | #6 - 4/0                     | 3/16 - 5/8      | 2-5/8 | 1/2  | 1-3/8 | 2-1/8 | 325                            |
| <b>KVSU34</b>  | 400 - 500 kcmil     | 336.4 - 397.5      | #4 - 500          | 5 - 397.5          | -                            | 3/4 - 3/4       | #4 - 4/0                     | 7/32 - 3/4      | 3     | 1/2  | 1-1/2 | 2-1/4 | 375                            |
| <b>KVSU40</b>  | 400 - 800 kcmil     | 4/0 - 800          | 4/0 - 800         | 3/0 - 715.5        | -                            | 3/4 - 1         | -                            | 1/2 - 1         | 3-1/2 | 1/2  | 1-5/8 | 2-1/2 | 500                            |
| <b>KVSU44</b>  | 500 - 1000 kcmil    | 4/0 - 1000         | 4/0 - 1000 kcmil  | 4/0 - 900          | -                            | 7/8 - 1 1/8     | -                            | 1/2 - 1 1/8     | 4     | 3/8  | 2     | 3     | 500                            |

Accommodates compressed conductors within diameter range. ✓ See note LIGHTNING PROTECTION INFO.

## TYPE KVS

### OKLIP™

**ACCOMMODATES:**  
COPPER, COPPERWELD

**MATERIAL:** COPPER

Compact, two-piece, high strength; high copper alloy BURNDY OKLIP™ recommended for heavy duty connections. Neoprene rings hold bolts in place during installation. Installed with ordinary wrench.

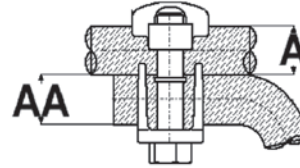
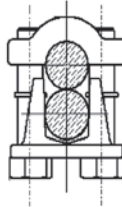

H-6

| Catalog Number | Conductor           |                       |                |        |      | Recommended Tightening Torque (in-lb) | Wrench Size (Cross flats) |
|----------------|---------------------|-----------------------|----------------|--------|------|---------------------------------------|---------------------------|
|                | Copper              |                       | Copperweld     |        |      |                                       |                           |
|                | Run (A)             | Tap (AA)              | Max. Run & Tap |        |      |                                       |                           |
|                |                     | Sol.                  | Str.           | Type V |      |                                       |                           |
| <b>KVS26</b>   | 1 Str. - 2/0 Str.   | 6 Str. - 2/0 Str.     | 3/0            | 7 #8   | —    | 180                                   | 1/2                       |
| <b>KVS28</b>   | 1/0 Str. - 4/0 Str. | 10 Str. - 4/0 Str.    | 4/0            | 7 #6   | V3/0 | 250                                   | 9/16                      |
| <b>KVS31</b>   | 250 - 350 kcmil     | 10 Str. - 350 kcmil   | —              | 19 #8  | V250 | 325                                   | 3/4                       |
| <b>KVS34</b>   | 400 - 500 kcmil     | 10 Str. - 500 kcmil   | —              | 19 #6  | V350 | 375                                   | 3/4                       |
| <b>KVS40</b>   | 400 - 800 kcmil     | 3/0 Str. - 800 kcmil  | —              | 19 #5  | —    | 500                                   | 3/4                       |
| <b>KVS44</b>   | 500 - 1000 kcmil    | 3/0 Str. - 1000 kcmil | —              | —      | —    | 500                                   | 15/16                     |

To ensure proper tightening torque use BURNDY® BTW Torque Wrenches.

## TYPE KVSW

### OKLIP™

**ACCOMMODATES:** COPPER,  
COPPERWELD

**MATERIAL:** COPPER

Similar to OKLIP™ Type KVS except for high copper alloy spacer that separates run and tap conductor. Provides high contact pressure, confines conductor strands, and assures vibration proof connection. Longer peened bolt, permits swivel action for easier installation.



| Catalog Number | Conductor           |                    | Wrench Size (Cross Flats) | Torque in - lb |
|----------------|---------------------|--------------------|---------------------------|----------------|
|                | Run                 | Tap                |                           |                |
| <b>KVSW26</b>  | 2 Str. - 2/0 Str.   | 6 Sol. - 2/0 Str.  | 1/2                       | 180            |
| <b>KVSW28</b>  | 1/0 Str. - 4/0 Str. | 6 Sol. - 4/0 Str.  | 9/16                      | 250            |
| <b>KVSW31</b>  | 250 - 350 kcmil     | 4 Sol. - 350 kcmil | 3/4                       | 325            |
| <b>KVSW34</b>  | 400 - 500 kcmil     | 4 Str. - 500 kcmil | 3/4                       | 375            |
| <b>KVSW40</b>  | 400 - 800 kcmil     | 4/0 - 800 kcmil    | 3/4                       | 500            |
| <b>KVSW44</b>  | 500 - 1000 kcmil    | 250 - 1000 kcmil   | 15/16                     | 500            |

To ensure proper tightening torque use BURNDY® BTW Torque Wrenches.