

Rigid Nonmetallic Conduit – Conduit Bodies



Except where noted by ▶

Conduit Bodies

- Hubs are not threaded
- Textured lids
- Foam-in-place gasket

Type LB

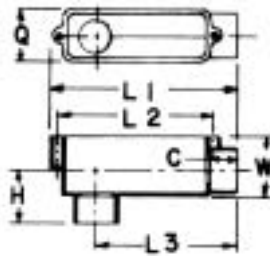
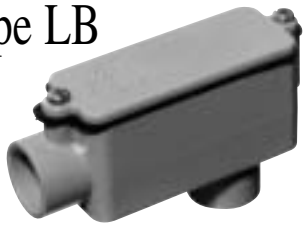

Part No.	Size	Std. Ctn. Qty.	C Typical	Max. L1	L2 Typical	L3	Max H	Max Q	Max. W	Vol. Cu. In.
E986D-CAR	1/2	10	1 ¹¹ / ₁₆	4 ⁵ / ₁₆	3 ⁷ / ₃₂	3 ¹ / ₁₆	1 ⁵ / ₁₆	1 ¹¹ / ₃₂	1 ¹ / ₂	4.0
E986E-CAR	3/4	10	2 ⁹ / ₃₂	6 ⁹ / ₃₂	5 ⁹ / ₃₂	4 ²⁵ / ₃₂	1 ²⁵ / ₃₂	1 ³ / ₄	2 ¹ / ₃₂	12.0
E986F-CAR	1	10	2 ⁹ / ₃₂	6 ⁹ / ₃₂	5 ⁹ / ₃₂	4 ²⁵ / ₃₂	1 ²⁵ / ₃₂	1 ³ / ₄	2 ¹ / ₃₂	12.0
E986G-CAR	1 ¹ / ₄	5	1 ³ / ₃₂	7 ³¹ / ₃₂	6 ¹³ / ₃₂	6	2 ⁵ / ₁₆	2 ¹ / ₂	2 ³ / ₄	32.0
E986H-CAR	1 ¹ / ₂	5	1 ³ / ₃₂	7 ³¹ / ₃₂	6 ¹³ / ₃₂	6	2 ⁵ / ₁₆	2 ¹ / ₂	2 ³ / ₄	32.0
E986J	2	10	1 ⁵ / ₃₂	9 ³¹ / ₃₂	8 ¹³ / ₃₂	7 ¹ / ₄	2 ⁹ / ₁₆	3 ⁵ / ₃₂	3 ¹⁵ / ₃₂	63.0
▶E986K	2 ¹ / ₂	4	1 ⁵ / ₈	14 ⁷ / ₈	13 ¹ / ₄	11 ³¹ / ₃₂	3 ³ / ₄	4 ¹¹ / ₃₂	4 ⁵ / ₈	210.
▶E986L	3	4	1 ⁵ / ₈	14 ⁷ / ₈	13 ¹ / ₄	11 ³¹ / ₃₂	3 ³ / ₄	4 ¹¹ / ₃₂	4 ⁵ / ₈	210.
▶E986M	3 ¹ / ₂	4	1 ²⁵ / ₃₂	17 ²³ / ₃₂	15 ⁷ / ₈	14 ¹⁷ / ₆₄	4 ⁷ / ₁₆	5 ¹¹ / ₃₂	5 ²¹ / ₃₂	390.
▶E986N	4	4	1 ²⁵ / ₃₂	17 ²³ / ₃₂	15 ⁷ / ₈	14 ¹⁷ / ₆₄	4 ⁷ / ₁₆	5 ¹¹ / ₃₂	5 ²¹ / ₃₂	390.

Type LR

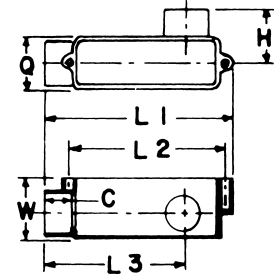

Part No.	Size	Std. Ctn. Qty.	C Typical	Max. L1	L2 Typical	L3	Max. H	Max. Q	Max. W	Vol. Cu. In.
E985D-CAR	1/2	10	1 ¹¹ / ₁₆	4 ⁵ / ₁₆	3 ⁷ / ₃₂	3 ¹ / ₁₆	1 ⁵ / ₁₆	1 ¹¹ / ₃₂	1 ¹ / ₂	4.0
E985E-CAR	3/4	10	2 ⁹ / ₃₂	6 ⁹ / ₃₂	5 ⁹ / ₃₂	4 ²⁵ / ₃₂	1 ²⁵ / ₃₂	1 ³ / ₄	2 ¹ / ₃₂	12.0
E985F-CAR	1	10	2 ⁹ / ₃₂	6 ⁹ / ₃₂	5 ⁹ / ₃₂	4 ²⁵ / ₃₂	1 ²⁵ / ₃₂	1 ³ / ₄	2 ¹ / ₃₂	12.0
E985G-CAR	1 ¹ / ₄	5	1 ³ / ₃₂	7 ³¹ / ₃₂	6 ¹³ / ₃₂	6	2 ⁵ / ₁₆	2 ¹ / ₂	2 ³ / ₄	32.0
E985H-CAR	1 ¹ / ₂	5	1 ³ / ₃₂	7 ³¹ / ₃₂	6 ¹³ / ₃₂	6	2 ⁵ / ₁₆	2 ¹ / ₂	2 ³ / ₄	32.0
E985J	2	10	1 ⁵ / ₃₂	9 ³¹ / ₃₂	8 ¹³ / ₃₂	7 ¹ / ₄	2 ⁹ / ₁₆	3 ⁵ / ₃₂	3 ¹⁵ / ₃₂	63.0

Type E

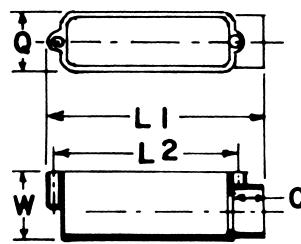
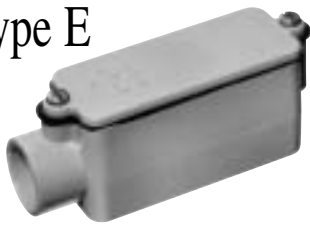

Part No.	Size	Std. Ctn. Qty.	C	L1	L2	Q	W	Vol. Cu. In.
E988D-CAR	1/2	5	1 ¹¹ / ₁₆	4 ⁵ / ₁₆	3 ¹ / ₂	1 ¹¹ / ₃₂	1 ¹ / ₂	4.0
E988E	3/4	20	2 ⁹ / ₃₂	6 ¹¹ / ₃₂	5 ⁹ / ₃₂	1 ³ / ₄	2 ¹ / ₃₂	12.0
E988F-CAR	1	10	2 ⁹ / ₃₂	6 ¹¹ / ₃₂	5 ⁹ / ₃₂	1 ³ / ₄	2 ¹ / ₃₂	12.0
E988G-CAR	1 ¹ / ₄	5	1 ³ / ₃₂	8	6 ¹³ / ₃₂	2 ¹ / ₂	2 ³ / ₄	32.0
E988H-CAR	1 ¹ / ₂	5	1 ³ / ₃₂	8	6 ¹³ / ₃₂	2 ¹ / ₂	2 ³ / ₄	32.0
E988J	2	5	1 ⁵ / ₃₂	9 ¹⁵ / ₃₂	8 ¹³ / ₃₂	3 ⁵ / ₃₂	3 ¹⁵ / ₃₂	63.0

Type T

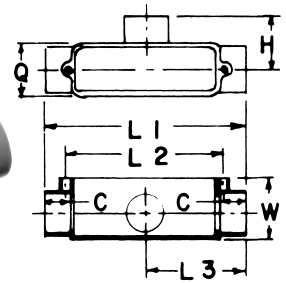

Part No.	Size	Std. Ctn. Qty.	C Typical	Max. L1	L2 Typical	L3	Max. H	Max. Q	Max. W	Vol. Cu. In.
E983D-CAR	1/2	10	1 ¹¹ / ₁₆	4 ¹¹ / ₁₆	3 ⁷ / ₃₂	2 ¹¹ / ₃₂	1 ⁵ / ₁₆	1 ¹¹ / ₃₂	1 ¹ / ₂	4.0
E983E-CAR	3/4	10	2 ⁹ / ₃₂	6 ⁷ / ₈	5 ⁹ / ₃₂	4 ⁷ / ₁₆	1 ²⁵ / ₃₂	1 ³ / ₄	2 ¹ / ₃₂	12.0
E983F	1	20	2 ⁹ / ₃₂	6 ⁷ / ₈	5 ⁹ / ₃₂	3 ⁷ / ₁₆	1 ²⁵ / ₃₂	1 ³ / ₄	2 ¹ / ₃₂	12.0
E983G	1 ¹ / ₄	10	1 ³ / ₃₂	8 ²¹ / ₃₂	6 ¹³ / ₃₂	4 ²¹ / ₆₄	2 ⁵ / ₁₆	2 ¹ / ₂	2 ³ / ₄	32.0
E983H-CAR	1 ¹ / ₂	4	1 ³ / ₃₂	8 ²¹ / ₃₂	6 ¹³ / ₃₂	4 ²¹ / ₆₄	2 ⁵ / ₁₆	2 ¹ / ₂	2 ³ / ₄	32.0
E983J	2	10	1 ⁵ / ₃₂	10 ⁵ / ₁₆	8 ¹³ / ₃₂	5 ⁹ / ₃₂	2 ⁹ / ₁₆	3 ⁵ / ₃₂	3 ¹⁵ / ₁₆	63.0

Type C

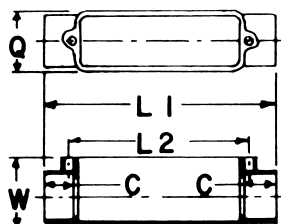
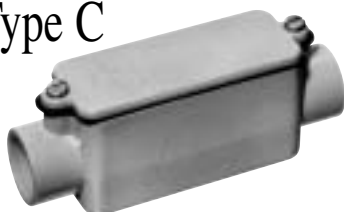

Part No.	Size	Std. Ctn. Qty.	C Typical	Max. L1	L2 Typical	Max. Q	Max. W	Vol. Cu. In.
E987D-CAR	1/2	10	1 ¹¹ / ₁₆	4 ¹¹ / ₁₆	3 ¹ / ₂	1 ¹¹ / ₃₂	1 ¹ / ₂	4.0
E987E-CAR	3/4	10	2 ⁹ / ₃₂	6 ⁷ / ₈	5 ³² / ₆₄	1 ³ / ₄	2 ¹ / ₃₂	12.0
E987F-CAR	1	10	2 ⁹ / ₃₂	6 ⁷ / ₈	5 ⁹ / ₃₂	1 ³ / ₄	2 ¹ / ₃₂	12.0
E987G-CAR	1 ¹ / ₄	5	1 ³ / ₃₂	8 ²¹ / ₃₂	6 ¹³ / ₃₂	2 ¹ / ₂	2 ³ / ₄	32.0
E987H-CAR	1 ¹ / ₂	4	1 ³ / ₃₂	8 ²¹ / ₃₂	6 ¹³ / ₃₂	2 ¹ / ₂	2 ³ / ₄	32.0
E987J	2	15	1 ⁵ / ₃₂	10 ⁵ / ₁₆	8 ¹³ / ₃₂	3 ⁵ / ₃₂	3 ¹⁵ / ₃₂	63.0

Type LL

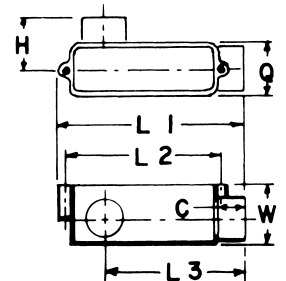
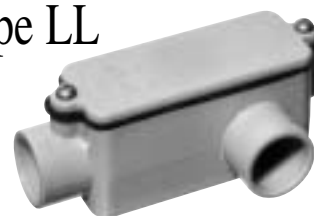

Part No.	Size	Std. Ctn. Qty.	C Typical	Max. L1	L2 Typical	L3	Max. H	Max. Q	Max. W	Vol. Cu. In.
E984D-CAR	1/2	10	1 ¹¹ / ₁₆	4 ⁵ / ₁₆	3 ⁷ / ₃₂	3 ¹ / ₁₆	1 ⁵ / ₁₆	1 ¹¹ / ₃₂	1 ¹ / ₂	4.0
E984E-CAR	3/4	8	2 ²⁹ / ₃₂	6 ⁹ / ₃₂	5 ⁹ / ₃₂	4 ²⁵ / ₃₂	1 ²⁵ / ₃₂	1 ³ / ₄	2 ¹ / ₃₂	12.0
E984F-CAR	1	10	2 ²⁹ / ₃₂	6 ⁹ / ₃₂	5 ⁹ / ₃₂	4 ²⁵ / ₃₂	1 ²⁵ / ₃₂	1 ³ / ₄	2 ¹ / ₃₂	12.0
E984G-CAR	1 ¹ / ₄	5	1 ³ / ₃₂	7 ³¹ / ₃₂	6 ¹³ / ₃₂	6	2 ⁵ / ₁₆	2 ¹ / ₂	2 ³ / ₄	32.0
E984H-CAR	1 ¹ / ₂	5	1 ³ / ₃₂	7 ³¹ / ₃₂	6 ¹³ / ₃₂	6	2 ⁵ / ₁₆	2 ¹ / ₂	2 ³ / ₄	32.0
E984J	2	10	1 ⁵ / ₃₂	9 ⁹ / ₃₂	8 ¹³ / ₃₂	7 ¹ / ₄	2 ⁹ / ₁₆	3 ⁵ / ₃₂	3 ¹⁵ / ₃₂	63.0
E984J-CAR	2	3	1 ⁵ / ₃₂	9 ⁹ / ₃₂	8 ¹³ / ₃₂	7 ¹ / ₄	2 ⁹ / ₁₆	3 ⁵ / ₃₂	3 ¹⁵ / ₃₂	63.0