

Conduit Bodies

Type LB

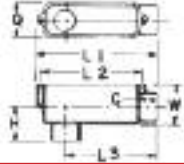

- Hubs are not threaded
- Textured lids
- Foam-in-place gasket



Cat. No.	Size (in.)	Std. Ctn. Qty.	C Typical	Max. L1 (in.)	L2 Typical (in.)	L3	Max. (in.)			Vol. Cu. in.
							H	Q	W	
E986D	1/2	25	11/16	4-5/16	3-7/32	3-1/16	1-5/16	1-11/32	1-1/2	4.0
E986E	3/4	15	29/32	6-9/32	5-9/32	4-25/32	1-25/32	1-3/4	2-1/32	12.0
E986F	1	10	29/32	6-9/32	5-9/32	4-25/32	1-25/32	1-3/4	2-1/32	12.0
E986G	1-1/4	10	1-3/32	7-31/32	6-13/32	6	2-5/16	2-1/2	2-3/4	32.0
E986H	1-1/2	10	1-3/32	7-31/32	6-13/32	6	2-5/16	2-1/2	2-3/4	32.0
E986J	2	10	1-5/32	9-31/32	8-13/32	7-1/4	2-9/16	3-5/32	3-15/32	63.0
E986K	2-1/2	4	1-5/8	14-7/8	13-1/4	11-31/32	3-3/4	4-11/32	4-5/8	210.0
E986L	3	4	1-5/8	14-7/8	13-1/4	11-31/32	3-3/4	4-11/32	4-5/8	210.0
E986M	3-1/2	4	1-25/32	17-23/32	15-7/8	14-17/64	4-7/16	5-11/32	5-21/32	390.0
E986N	4	4	1-25/32	17-23/32	15-7/8	14-17/64	4-7/16	5-11/32	5-21/32	390.0

Type LR



- Hubs are not threaded
- Textured lids
- Foam-in-place gasket

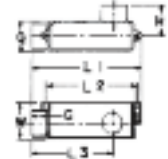

Cat. No.	Size (in.)	Std. Ctn. Qty.	C Typical	Max. L1	L2 Typical (in.)	L3	Max. (in.)			Vol. Cu. in.
							H	Q	W	
E985D-CAR	1/2	10	11/16	4-5/16	3-7/32	3-1/16	1-5/16	1-11/32	1-1/2	4.0
E985E-CAR	3/4	10	29/32	6-9/32	5-9/32	4-25/32	1-25/32	1-3/4	2-1/32	12.0
E985F-CAR	1	10	29/32	6-9/32	5-9/32	4-25/32	1-25/32	1-3/4	2-1/32	12.0
E985G-CAR	1-1/4	5	1-3/32	7-31/32	6-13/32	6	2-5/16	2-1/2	2-3/4	32.0
E985H-CAR	1-1/2	5	1-3/32	7-31/32	6-13/32	6	2-5/16	2-1/2	2-3/4	32.0
E985J-CAR	2	3	1-5/32	9-9/32	8-13/32	7-1/4	2-9/16	3-5/32	3-15/32	63.0

Type E



- Hubs are not threaded
- Textured lids
- Foam-in-place gasket

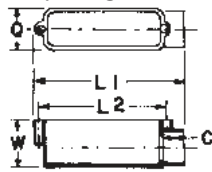

Cat. No.	Size (in.)	Std. Ctn. Qty.	C (in.)	L1 (in.)	L2 (in.)	Q (in.)	W (in.)	Vol. Cu. in.
E988E	3/4	15	29/32	6-11/32	5-9/32	1-3/4	2-1/32	12.0
E988F	1	10	29/32	6-11/32	5-9/32	1-3/4	2-1/32	12.0
E988G	1-1/4	10	1-3/32	8	6-13/32	2-1/2	2-3/4	32.0
E988H	1-1/2	10	1-3/32	8	6-13/32	2-1/2	2-3/4	32.0
E988J	2	10	1-5/32	9-15/32	8-13/32	3-5/32	3-15/32	63.0

Type T



- Hubs are not threaded
- Textured lids
- Foam-in-place gasket

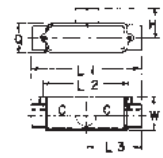

Cat. No.	Size (in.)	Std. Ctn. Qty.	C Typical (in.)	Max. L1 (in.)	L2 Typical (in.)	L3	Max. (in.)			Vol. Cu. in.
							H	Q	W	
E983D-CAR	1/2	10	11/16	4-11/16	3-7/32	2-11/32	1-5/16	1-11/32	1-1/2	4.0
E983E	3/4	15	29/32	6-7/8	5-9/32	4-7/16	1-25/32	1-3/4	2-1/32	12.0
E983F	1	20	29/32	6-7/8	5-9/32	3-7/16	1-25/32	1-3/4	2-1/32	12.0
E983G	1-1/4	10	1-3/32	8-21/32	6-13/32	4-21/64	2-5/16	2-1/2	2-3/4	32.0
E983H	1-1/2	4	1-3/32	8-21/32	6-13/32	4-21/64	2-5/16	2-1/2	2-3/4	32.0
E983J	2	10	1-5/32	10-5/16	8-13/32	5-5/32	2-9/16	3-5/32	3-15/16	63.0

Type C



- Hubs are not threaded
- Textured lids
- Foam-in-place gasket

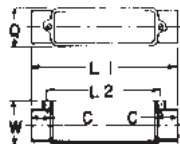

Cat. No.	Size (in.)	Std. Ctn. Qty.	C Typical (in.)	Max. L1 (in.)	L2 Typical (in.)	Max. (in.)		Vol. Cu. in.
						Q	W	
E987D-CTN	1/2	8	11/16	4-11/16	3-1/2	1-11/32	1-1/2	4.0
E987E-CAR	3/4	10	29/32	6-7/8	5-32/64	1-3/4	2-1/32	12.0
E987F-CAR	1	10	29/32	6-7/8	5-9/32	1-3/4	2-1/32	12.0
E987G-CAR	1-1/4	5	1-3/32	8-21/32	6-13/32	2-1/2	2-3/4	32.0
E987H-CAR	1-1/2	4	1-3/32	8-21/32	6-13/32	2-1/2	2-3/4	32.0
E987J	2	15	1-5/32	10-5/16	8-13/32	3-5/32	3-15/32	63.0

Type LL



- Hubs are not threaded
- Textured lids
- Foam-in-place gasket

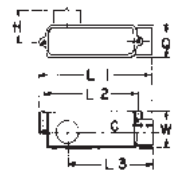

Cat. No.	Size (in.)	Std. Ctn. Qty.	C Typical (in.)	Max. L1 (in.)	L2 Typical (in.)	L3	Max. (in.)			Vol. Cu. in.
							H	Q	W	
E984D-CAR	1/2	10	11/16	4-5/16	3-7/32	3-1/16	1-5/16	1-11/32	1-1/2	4.0
E984E	3/4	20	29/32	6-9/32	5-9/32	4-25/32	1-25/32	1-3/4	2-1/32	12.0
E984F-CAR	1	10	29/32	6-9/32	5-9/32	4-25/32	1-25/32	1-3/4	2-1/32	12.0
E984G	1-1/4	10	1-3/32	7-31/32	6-13/32	6	2-5/16	2-1/2	2-3/4	32.0
E984H	1-1/2	10	1-3/32	7-31/32	6-13/32	6	2-5/16	2-1/2	2-3/4	32.0
E984J	2	10	1-5/32	9-9/32	8-13/32	7-1/4	2-9/16	3-5/32	3-15/32	63.0