



Hubbell Wiring Device-Kellems offers a full line of innovative, high quality, Series 15 and Series 16 single pole plugs, receptacles and accessories.

Single pole devices are the right choice for supplying temporary electrical power distribution for entertainment, theme parks, carnival equipment, concerts, movie making, and numerous other applications requiring temporary power.

Single pole devices have been designed with ease of assembly and disassembly in mind, no special tools are required. A high strength non-conductive retaining screw is all that is needed to securely lock the contacts to the insulated sleeve.



### Male Plug

Insulgrip® Style Housing for Superior Gripping conforms to the user's hand making it easy to connect and disconnect, even with gloves on

Non-Conductive Retaining Screw locks contacts in place and allows for easy installation. Prevents contact movement within housing. Special screw thread requires fewer turns than most competitors and reduces the risk of a conductive screw being substituted



Rounded Corners reduce the possibility of catching or snagging on structures or equipment

Large Raised Alignment Arrow aids in the mating of devices and provides a visual indication that the devices are properly connected

UL Enclosure Types 3R, 4X and 12 Rating suitable for use in almost any environment

Double Cam Design provides high contact pressure and vibration resistant connection, which helps reduce operating temperatures and extends life

### Female Plug

High Conductivity Brass Contact provides improved performance by helping to reduce operating temperatures and extends life

Turn and Lock Symbol aids in the mating of devices and provides a clear indication that the devices are properly connected

Easily Identifiable Cable with cut off points for secure fit allows you to easily customize the housing to the required cable size. Makes cutting to the correct cable size very easy. Accommodates wide range of cables



Extra Long non-conductive inner sleeve reduces force required to install housing over contacts. Easier to rotate contact in body for installing retaining screw

Strip Gauge molded into every plug and receptacle housing. Simplifies installation and saves time



**Plugs**

Description	Color	Male Plug	Female Plug
300 amp, thermoplastic elastomer, cable size #6 - 2/0 AWG.	Black	<b>HBL300MBK</b>	<b>HBL300FBK</b>
	White	<b>HBL300MW</b>	<b>HBL300FW</b>
	Green	<b>HBL300MGN</b>	<b>HBL300FGN</b>
	Red	<b>HBL300MR</b>	<b>HBL300FR</b>
	Blue	<b>HBL300MBL</b>	<b>HBL300FBL</b>
	Brown	<b>HBL300MBN</b>	<b>HBL300FBN</b>
	Orange	<b>HBL300MO</b>	<b>HBL300FO</b>
	Yellow	<b>HBL300MY</b>	<b>HBL300FY</b>
	Gray	—	—



Description	Color	Male Plug	Female Plug
400 amp, thermoplastic elastomer, cable size 2/0 - 4/0 AWG.	Black	<b>HBL400MBK</b>	<b>HBL400FBK</b>
	White	<b>HBL400MW</b>	<b>HBL400FW</b>
	Green	<b>HBL400MGN</b>	<b>HBL400FGN</b>
	Red	<b>HBL400MR</b>	<b>HBL400FR</b>
	Blue	<b>HBL400MBL</b>	<b>HBL400FBL</b>
	Brown	<b>HBL400MBN</b>	<b>HBL400FBN</b>
	Orange	<b>HBL400MO</b>	<b>HBL400FO</b>
	Yellow	<b>HBL400MY</b>	<b>HBL400FY</b>
	Gray	<b>HBL400MGY</b>	<b>HBL400FGY</b>

**Receptacles, Female Stud Type**



Description	Color	Through Hole Mounting	Threaded Mounting Holes
400 amp Panel Mount, thermoplastic elastomer, mates with 300 and 400 amp plugs.	Black	<b>HBLFRSBK</b>	<b>HBLFRSCBK</b>
	White	<b>HBLFRSW</b>	<b>HBLFRSCW</b>
	Green	<b>HBLFRSGN</b>	<b>HBLFRSCGN</b>
	Red	<b>HBLFRSR</b>	<b>HBLFRSCR</b>
	Blue	<b>HBLFRSBL</b>	<b>HBLFRSCBL</b>
	Brown	<b>HBLFRSBN</b>	<b>HBLFRSCBN</b>
	Orange	<b>HBLFRSO</b>	<b>HBLFRSCO</b>
	Yellow	<b>HBLFRSY</b>	<b>HBLFRSCY</b>

**Receptacles, Male Stud Type**



Description	Color	Through Hole Mounting	Threaded Mounting Holes
400 amp Panel Mount, thermoplastic elastomer, mates with 300 and 400 amp plugs.	Black	<b>HBLMRSBK</b>	<b>HBLMRSGBK</b>
	White	<b>HBLMRSW</b>	<b>HBLMRSW</b>
	Green	<b>HBLMRSGN</b>	<b>HBLMRSCGN</b>
	Red	<b>HBLMRSR</b>	<b>HBLMRSCR</b>
	Blue	<b>HBLMRSBL</b>	<b>HBLMRSCBL</b>
	Brown	<b>HBLMRSBN</b>	<b>HBLMRSCBN</b>
	Orange	<b>HBLMRSO</b>	<b>HBLMRSCO</b>
	Yellow	<b>HBLMRSY</b>	<b>HBLMRSCY</b>

**Receptacles, Double Set Screw**



Description	Color	Female Receptacles	Male Receptacles
400 amp Panel Mount, thermoplastic elastomer, cable size #4 - 4/0 AWG, mates with 300 and 400 amp plugs.	Black	<b>HBLFRBK</b>	<b>HBLMRBK</b>
	White	<b>HBLFRW</b>	<b>HBLMRW</b>
	Green	<b>HBLFRGN</b>	<b>HBLMRGN</b>
	Red	<b>HBLFRR</b>	<b>HBLMRR</b>
	Blue	<b>HBLFRBL</b>	<b>HBLMRBL</b>
	Brown	<b>HBLFRBN</b>	<b>HBLMRBN</b>
	Orange	<b>HBLFRO</b>	<b>HBLMRO</b>
	Yellow	<b>HBLFRY</b>	<b>HBLMRY</b>
	Gray	<b>HBLFRGY</b>	<b>HBLMRGY</b>

**Receptacles, Bus Bar Mount**



Description	Color	Female Receptacles	Male Receptacles
400 amp Mount, thermoplastic elastomer, mates with 300 and 400 amp plugs.	Black	<b>HBLFRBBK</b>	<b>HBLMRBBK</b>
	White	<b>HBLFRBW</b>	<b>HBLMRBW</b>
	Green	<b>HBLFRBGN</b>	<b>HBLMRBGN</b>
	Red	<b>HBLFRBR</b>	<b>HBLMRBR</b>
	Blue	<b>HBLFRBBL</b>	<b>HBLMRBBL</b>
	Brown	<b>HBLFRBBN</b>	<b>HBLMRBBN</b>
	Orange	<b>HBLFRBO</b>	<b>HBLMRBO</b>
	Yellow	<b>HBLFRBY</b>	<b>HBLMRBY</b>
	Gray	—	—

**Protective Caps**



Color	Fits Female Devices	Fits Male Devices
Black	<b>HBLFCAPBK</b>	<b>HBLMCAPBK</b>
White	<b>HBLFCAPW</b>	<b>HBLMCAPW</b>
Green	<b>HBLFCAPGN</b>	<b>HBLMCAPGN</b>
Red	<b>HBLFCAPR</b>	<b>HBLMCAPR</b>
Blue	<b>HBLFCAPBL</b>	<b>HBLMCAPBL</b>
Brown	<b>HBLFCAPBN</b>	<b>HBLMCAPBN</b>
Orange	<b>HBLFCAPO</b>	<b>HBLMCAPO</b>
Yellow	<b>HBLFCAPY</b>	<b>HBLMCAPY</b>

**Weather Protective Lift Covers**



Color	Catalog Number	All One Color Caps and Bodies
Clear	—	<b>HBLNCC</b>
Black	<b>HBLNCBK</b>	<b>HBLNCABK</b>
White	<b>HBLNCW</b>	<b>HBLNCAW</b>
Green	<b>HBLNCGN</b>	<b>HBLNCAGN</b>
Red	<b>HBLNCR</b>	<b>HBLNCAR</b>
Blue	<b>HBLNCBL</b>	<b>HBLNCABL</b>
Brown	<b>HBLNCBN</b>	<b>HBLNCABN</b>
Orange	<b>HBLNCO</b>	<b>HBLNCAO</b>
Yellow	<b>HBLNCY</b>	<b>HBLNCAY</b>



**Specifications**

<b>Electrical</b>	
Voltage Ratings	600V AC Maximum. 250V DC Maximum.
Amperage Rating	400A Maximum.
<b>Mechanical</b>	
Terminal Accommodation	Plug- 300A - #6 to 2/0 AWG. Plug- 400A - 2/0 to 4/0 AWG. Recept.- 400A - #4 to 4/0 AWG.
Product Identification	Ratings are a permanent part of device.
Base Compound	Thermoplastic Elastomer (TPE).
Contact Material	Brass.
Retaining Screw Material	Nylon.

<b>Certification / Environmental</b>	
UL and cUL Listed.	
UL Enclosure Types 3R, 4X, 12.	
Flammability: HB per UL94 or CSA 22.2. 0.17.	
UL 498 for attachment plugs and receptacles.	
UL 1691 draft standard for single pin and sleeve devices intended for theatre, stage and studio applications (Series 16 pending).	
National Electric Code (NEC®), ANSI/NFPA 70.	

**Conductor Ampacity Chart (Type SC/PPC Wire)**

Cable Size	Ampacity*
#4	140
#2	190
2/0	300
4/0	405

Note: \*90°C column NEC Table 400.5(A)(2).

**Dimensions**

**Series 16 Threaded Stud**

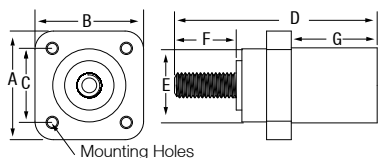

**Panel Mount Receptacles**

Threaded Stud	A	B	C	D	E	F	G	Mounting Hole	Termination
Male & Female w/ through hole mounting	2.20" (55.9)	2.20" (55.9)	1.50" (38.1)	4.10" (104.3)	1.48" (47.4)	1.25" (31.7)	1.74" (44.2)	Through 4x Ø .20"	1/2-13 UNC-2A Threaded Stud
Male & Female w/ threaded mounting holes	2.20" (55.9)	2.20" (55.9)	1.50" (38.1)	3.67" (93.2)	1.48" (47.4)	1.11" (28.2)	1.55" (39.4)	Threaded 4x #10-32	1/2-13 UNC-2A Threaded Stud
Double Set Screw	A	B	C	D	E	F	G	Mounting Hole	Termination
Male & Female w/ threaded mounting holes	2.20" (55.9)	2.20" (55.9)	1.50" (38.1)	4.10" (104.3)	1.48" (47.4)	1.36" (34.5)	1.74" (44.2)	Threaded 4x #10-32	(2) 7/32 Socket Head Set Screws
Busbar Type	A	B	C	D	E	F	G	Mounting Hole	Termination
Male & Female w/ threaded mounting holes	2.20" (55.9)	2.20" (55.9)	1.50" (38.1)	3.57" (90.7)	1.48" (37.6)	1.01" (25.7)	1.55" (39.4)	Threaded 4x #10-32	(1) 5/16-18 UNC-2B Threaded Hole

**Series 16 Double Set Screw**

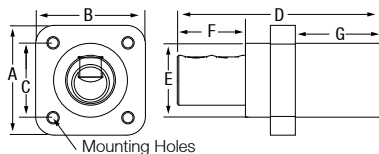

**Series 16 Busbar Type**

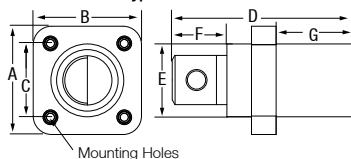

**Series 16 Inline Plug Male**

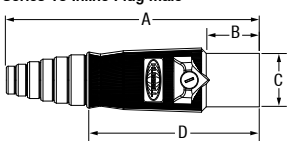

**Series 16 Inline Plug Female**

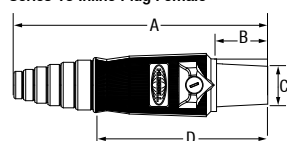

**Series 16 Double Male**

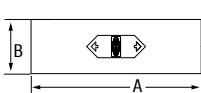

**Series 16 Double Female**

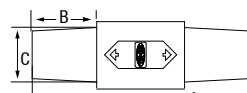

**Series 16 Tapping Tee**

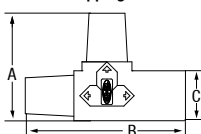

**Series 16 Paralleling Tee**

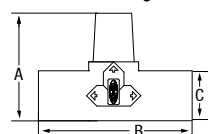

**Series 16 3-FER**

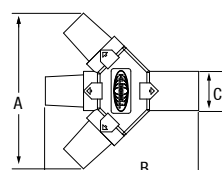

**Series 16 Weatherproof Cover**

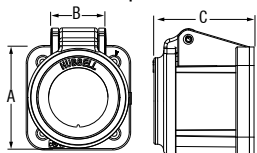

**Series 16 Snap Back Cover**

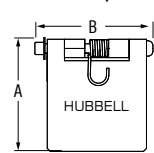

Dimensions in Inches (mm)

**Inline Plugs**

	A	B	C	D
Male	7.01" (178.0)	1.38" (35.1)	1.48" (37.6)	4.78" (121.4)
Female	7.10" (180.5)	1.44" (36.6)	1.06" (27.0)	4.90" (121.3)

**Gender Reversing Devices**

	A	B	C
Double Male	4.65" (118.1)	1.48" (37.6)	—
Double Female	4.84" (122.9)	1.44" (36.6)	1.06" (27.0)

**Tees and 3-Fers**

	A	B	C
Tapping Tee	3.18" (80.8)	4.74" (120.4)	1.48" (37.6)
Paralleling Tee	3.18" (80.8)	4.65" (118.1)	1.48" (37.6)
3-Fer	5.88" (149.3)	5.78" (146.9)	1.48" (37.6)

**Covers**

	A	B	C
Weatherproof Cover	2.20" (55.88)	1.16" (29.44)	2.03" (51.5)
Snap Back Cover to be used with receptacles	2.26" (57.4)	2.37" (60.2)	—

NEC® is a registered trademark of the National Fire Protection Association (NFPA).