

## FS Boxes and Covers

---



### Applications :

- FS boxes are CSA approved for wet locations
- FS device boxes are installed in applications that require a rugged unit to accept wiring devices, switches, electronic components and terminal blocks
- FS device boxes provide spacious accessible wiring chambers that are a convenient location to maintain or change a system; pull conductors; make splices or branch conduits
- FS device boxes, when used with an appropriate cover, provide a raintight installation
- Both weatherproof and dry location covers are available

### Features/Benefits :

- FS device boxes are sand casted or die casted using copper free (less than 0.004 copper content) aluminum alloys.
- FS device boxes incorporate external hub design that provides maximum wiring capacity
- FS device boxes have precision molded NPT threaded hubs allowing trouble-free field installation of rigid conduit
- FS device boxes are available in 1-7/8 in. and 2-5/8 in. depth
- Carlton® nonmetallic weatherproof FS covers are UV resistant, flame retardant and non-corrosive



### Standard Materials :

- CIFS and CIFD device boxes: sand cast, copper free aluminum (less than 0.004 copper content)
- CIFSU: die cast, copper free aluminum (less than 0.004 copper content)
- FS covers: die cast aluminum, sand cast aluminum or nonmetallic



### Compliances :

Compliances as noted on each page of the catalogue include:

- CSA Certified
- UL Listed



## FS Boxes and Covers



CIFSFS (1 face)



CIFSST (2 faces)

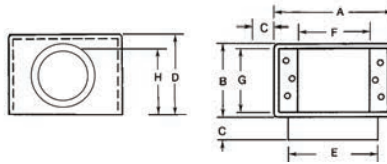

Cat. No.	Hub Size (in.)	No. of Gangs	No. of Lugs	A (in.)	B (in.)	C (in.)	D (in.)	E (in.)	F (in.)	G (in.)	H (in.)	J (in.)	Cu (in.)
<b>FSF Box - 3 in. Deep (Cast Aluminum)</b>													
CIFSFS	2	-	-	4-5/16	2-3/4	31/32	2-7/8	2-7/8	2-13/16	2-13/32	1-15/32	-	30.5
<b>FST Box - 3-5/8 in. Deep (Cast Aluminum)</b>													
CIFSST	2	-	-	4-5/16	2-3/4	1-3/8	3-3/8	3	2-7/8	2-5/16	2-13/16	-	38.7



CIFSU

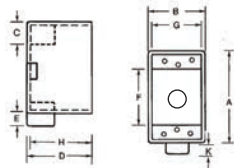

Cat. No.	Hub Size (in.)		No. of Lugs	A (in.)	B (in.)	C (in.)	D (in.)	E (in.)	F (in.)	G (in.)	H (in.)	K (in.)	Cu (in.)
<b>Universal FSU Boxes - 2-3/8 in. Deep (Cast Aluminum)</b>													
	<b>End</b>	<b>Bottom</b>											
CIFSU-1/2	2 x 1/2	1/2	2	4-5/16	2-3/4	13/16	2-3/8	1-1/8	2-13/16	2-1/2	1-29/32	7/16	18.5
CIFSU-3/4	2 x 3/4	3/4	2	4-5/16	2-3/4	13/16	2-3/8	1-1/8	2-13/16	2-1/2	2	7/16	18.5

Supplied with close up plugs



FG-09080

Cat. No.	Description
<b>Mounting Lugs for CI-FSU</b>	
FG-09080	Mounting lugs for a 3-Hole universal FSU box, 2-3/8 in. deep