

FS Boxes and Covers

Single Gang

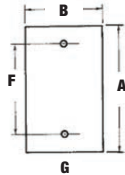

CCB



CCB-FS



CFSB

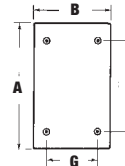

CIFS-100G



N° de catalogue	Description	A (in.)	B (in.)	F (in.)	G (in.)
Single Gang Blank Covers (Cast Aluminum)					
CCB	Silver – device mount (stamped aluminum)	4-9/16	2-13/16	3-9/32	–
CCB-FS	Silver – box mount (stamped aluminum)	4-9/16	2-13/16	3-1/4	1-7/8
CFSB	Blank – box mount	4-9/16	2-13/16	3-1/4	1-7/8
CIFS-100G	Blank – box mount (gasket glued on cover)	4-3/8	2-14/16	3-1/4	1-7/8



CFSR Series

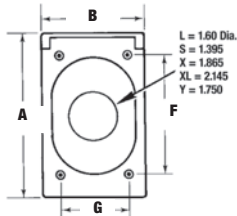

Cat. No.	Description	Nominal Size (in.)	Max. Device Face Dia.	A (in.)	B (in.)	F (in.)	G (in.)
Single Gang Vertical Covers (Cast Aluminum)							
CFSR-L	Single receptacle – box mount	1-9/16	1.600	4-9/16	2-13/16	3-1/4	1-7/8
CFSR-S	Single receptacle – box mount	1-3/8	1.395	4-9/16	2-13/16	3-1/4	1-7/8
CFSR-X	Single receptacle – box mount	1-27/32	1.865	4-9/16	2-13/16	3-1/4	1-7/8
CFSR-XL	Single receptacle – box mount	2-1/8	2.145	4-9/16	2-13/16	3-1/4	1-7/8
CFSR-Y	Single receptacle – box mount	1-3/4	1.750	4-9/16	2-13/16	3-1/4	1-7/8



FS-GKV

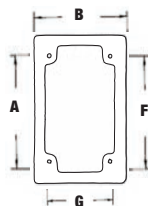

Cat. No.	Description	A (in.)	B (in.)	F (in.)	G (in.)
Single Gang Gasket					
FS-GKV*	Single Gang – box mount – gasket	4-9/16	2-13/16	3-1/4	1-7/8

* CSA not applicable