

Internal Accessories

Shunt Trip, Undervoltage Release, Auxiliary Switches, and Alarm Switches are operational devices that are contained within a field installable module for the EG/EB circuit breakers.

Shunt Trip — A shunt trip is used to trip the breaker remotely. It is operated by providing voltage to the shunt trip coil. The coil in this device is designed to be energized only momentarily, so included is a built-in limit switch which opens the coil circuit after the breaker trips. With the circuit breaker in the tripped position, voltage cannot be applied through the coil circuit due to the open contacts in the limit switch. The typical operational range of this device is (70 to 110%) of the marked voltage rating.

Under Voltage Release — An under voltage release (UVR) is used to trip the breaker remotely when supply voltage drops below 70% of the marked voltage rating. The UVR also prevents the circuit breaker from being reclosed until the supply voltage is restored to at least 85% of its marked rating.

Auxiliary Switches — Auxiliary switches are used for remote indication of breaker contact position (ON or OFF). Each switch consists of "A" (open when the breaker contacts are open) and "B" (closed when the breaker contacts are open) contacts with a common connection. These devices are typically used for signaling purposes.

Alarm Switch — The alarm switch provides indication of breaker tripping. Alarm contacts operate off of the tripping mechanism of the circuit breaker and only change state when the breaker is tripped. Each alarm switch consists of 1 "A" (open when the breaker contacts are open) and 1 "B" (closed when the breaker contacts are open) contact, with a common connection. This device is also known as a Bell Alarm.

A Shunt Trip or Undervoltage Release can only be installed in the left accessory pockets.

The Auxiliary Switches and/or Alarm Switch can only be installed in the right accessory pocket.

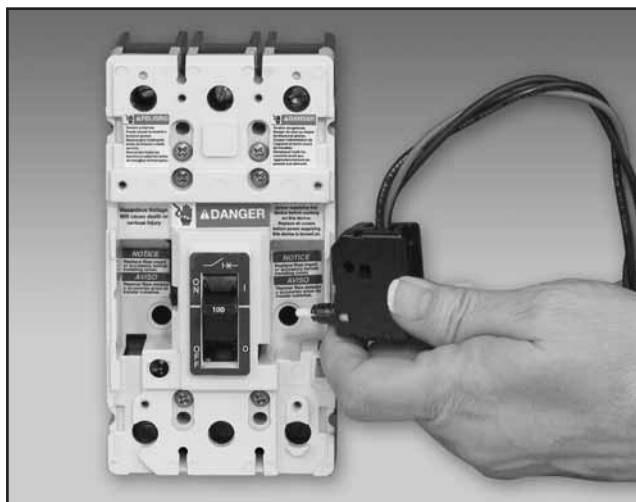
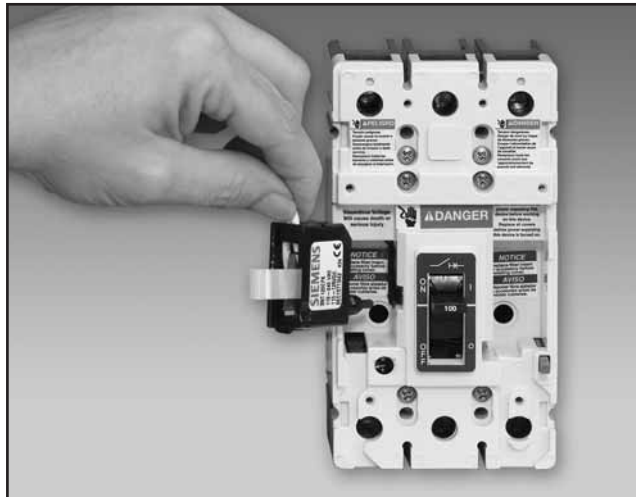

Available Accessory Combinations

Left Accessory Pocket	Right Accessory Pocket	
Shunt Trip or UVR	Auxiliary Switch Contacts	Alarm Contacts
Maximum 1 Shunt Trip or UVR	1A - 1B	0
	2A - 2B	0
	0	1A - 1B
	0	2A - 2B
	1A - 1B	1A - 1B

2-pole breakers can only accept right pocket accessories.
1-pole breakers cannot accept any internal accessories.

External Accessories

Terminal Connectors

Breaker Amp Rating (A)	Wire Size (AWG)	Torque (lb. - in.)	Connector Material	Connector Kit Catalog Number
15 - 125	14 - 10 AWG	35	Steel (Cu wire only)	3TW1EG30 (kit of 3)
	8 AWG	40		
	6 - 4 AWG	45		
	3 - 3/0 AWG	50		
	14 - 10 AWG	35	Aluminum (Cu/Al wire)	3TA1EG10 (kit of 3)
	8 AWG	40		
	6 - 4 AWG	45		
	3 - 1/0 AWG	50		
	6 - 2 AWG	80	Aluminum (Cu/Al wire)	3TA1EG30 (kit of 3)
1 - 3/0 AWG				



3TW1EG30

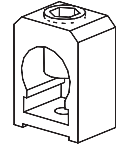

3TA1EG10

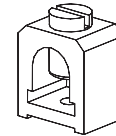

3TA1EG30

Nut Keeper Plates (for connecting ring terminals)

Breaker Amp Rating (A)	Catalog Number
15 - 125	TNKE3 (3-pole kit)
	TNKE4 (4-pole kit)



TNKE3

Power Distribution Connectors

Breaker Amp Rating (A)	Wire Size (AWG)	Torque (lb. - in.)	Connector Material	Connector Kit Catalog Number
15 - 125	3 holes, 14 - 2 AWG	70	Aluminum (Cu/Al wire)	3TA3EG02 (kit of 3)
	6 holes, 14 - 6 AWG	25	Aluminum (Cu/Al wire)	3TA6EG06 (kit of 3)

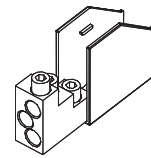

3TA3EG02

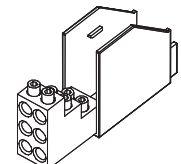

3TA3EG06

Connector Accessories

Description	Quantity per Kit	Accessory Kit Catalog Number
Control Wire Terminals (for use with terminal connectors)	12	12CWTE
Interphase barriers	2	IPBE

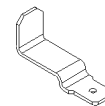

12CWTE

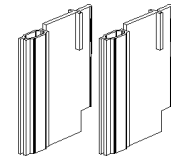

IPBE

Rear Connecting Studs

Breaker Amp Rating (A)	Description	Extension Behind the Breaker	Catalog Number (Quantity 1)
15 - 125	Long Rear Connecting Stud (with Spacer Tube)	3.6 in.	RTLCLR
	Short Rear Connecting Stud (with Spacer Tube)	6 in.	RTLESR



RTLCLR



RTLESR