

Steel City®

Weatherproof Outlet Boxes

B

Steel City®

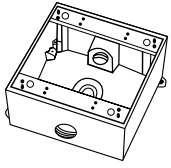

LT11
LT14

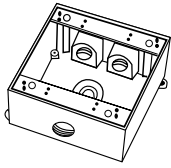

LT11-2
LT11-4

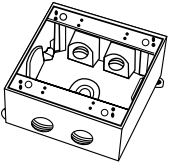

LT11-3
LT14-3

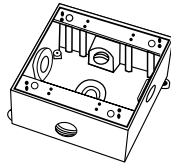

LTX11-5
LTX14-5

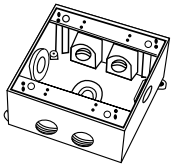

LTX11-7
LTX14-7

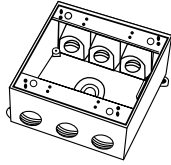

LT11-33
LT14-33

All two gang boxes are now standard with lugs.

- Heavy duty die cast aluminum construction.
- Accurately threaded mounting plate.
- Powder Coat finish in silver gray, bronze, or white.
- Boxes supplied with two closure plugs and #10-32 self-threading ground screw.

Two Gang Outlet Boxes

Cat. No.	Cubic In.	Description		Mounting Methods	Finish	Std. Ctn.
		No. of Outlet Holes	Outlet Hole Dia.			
LT11	31.8	3	1/2"	Lugs	Gray	10
LT14	31.8	3	3/4"	Lugs	Gray	10
LT11-2	31.8	4	1/2"	Lugs	Gray	10
LT14-2	31.8	4	3/4"	Lugs	Gray	10
LT11-3	31.8	5	1/2"	Lugs	Gray	10
LT14-3	31.8	5	3/4"	Lugs	Gray	10
LTX11-5	31.8	5	1/2"	Lugs	Gray	10
LTX14-5	31.8	5	3/4"	Lugs	Gray	10
LTX100-5	30	5	1"	Lugs	Gray	10
LTX11-7	31.8	7	1/2"	Lugs	Gray	10
LTX14-7	31.8	7	3/4"	Lugs	Gray	10
LT11-33	30.3	7	1/2"	Lugs	Gray	10
LT14-33	30.3	7	3/4"	Lugs	Gray	10

U.L. Listed E-18407
CSA Certified LR-18685

Two Gang Boxes

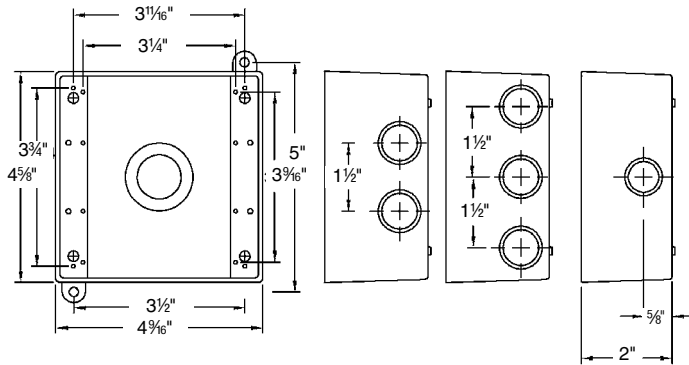

LT Series