

SPLIT-BOLT CONNECTORS

Blackburn® HPS Plated Split-Bolt Connectors with Spacer

Put the squeeze on conductors.



Features	Benefits/Descriptions
Bolt and Pressure Bar Made of Copper Alloy and Tin Plated	Provide high strength and corrosion resistance.
Most Connectors Are Standards Compliant for Copper Conductors 	UL 486A Listed and CSA Certified.

Blackburn® HPS Split-Bolt Connectors

CAT. NO.	Conductor Range (AWG or kcmil)			Dimensions (in.)			
	Range for Equal Main and Tap ACSR	Range for Equal Main and Tap CU or AL	Min. Tap with One Max. Main CU or AL	A	B	C	D
H-9HPS	—	#10 str.—#12 sol.	#12 sol.	3/8	0.146	1/2	29/32
H-8HPS	—	#8 str.—#12 sol.	#12 sol.	3/8	0.146	1/2	29/32
H-6HPS	#8	#6 sol.—#12 sol.	#12 sol.	15/32	0.170	21/32	1-1/8
H-4HPS	#6—#8	#4 sol.—#12 sol.	#12 sol.	17/32	0.235	23/32	1-9/32
H-2HPS	#4—#8	#2 sol.—#12 sol.	#8 sol.	19/32	0.271	25/32	1-15/32
H-1HPS	#2—#8	#1 str.—#8 sol.	#8 sol.	11/16	0.330	7/8	1-5/8
H-10HPS	#1—#6	1/0 str.—#6 sol.	#6 sol.	3/4	0.385	15/16	1-13/16
H-20HPS	1/0—#6	2/0 str.—#6 str.	#6 sol.	7/8	0.443	1-1/16	2-1/16
H-40HPS	4/0—#4	4/0 str.—#4 sol.	#4 sol.	1	0.580	1-5/16	2-15/32
H-350HPS	266.8—1/0	350—1/0 str.	#2 sol.	1-5/16	0.717	1-21/32	2-11/16
H-500HPS*	397.5—1/0	500—1/0 str.	1/0 str.	1-1/2	0.842	1-7/8	3-1/32
H-750HPS*	666.6—4/0	750—4/0 str.	2/0 str.	1-15/16	1.029	2-1/4	3-21/32
H-1000HPS*	900—477	1000—500	3/0 str.	2-1/4	1.185	2-17/32	4-1/32

* Not UL Listed or CSA Certified.
NOTE: Oxide inhibitor recommended when used with aluminum conductors.
For more information, please consult your Thomas & Betts representative.

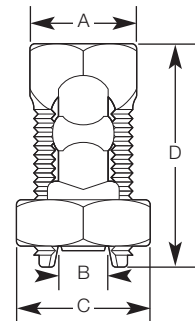

Grounding Products

Blackburn® HPW Plated Split-Bolt Connectors with Spacer and Washer

For use on combinations of conductors.



Features	Benefits/Descriptions
Bolt and Pressure Bar Made of Copper Alloy and Tin Plated	Provide high strength and corrosion resistance.
Contoured Spacer and Bell-Mouth Washer	Distribute pressure over much of the conductor.
Standards Compliant	UL Listed and CSA Certified.

Blackburn® HPW Split-Bolt Connectors

CAT. NO.	Conductor Range (AWG or kcmil)			Dimensions (in.)			
	Range for Equal Main and Tap ACSR	Range for Equal Main and Tap CU or AL	Min. Tap with One Max. Main CU or AL	A	B	C	D
H6HPW	#8	#6 sol.—#12 sol.	#12 sol.	15/32	0.170	21/32	1-1/8
H4HPW	#6—#8	#4 sol.—#12 sol.	#12 sol.	17/32	0.235	23/32	1-9/32
H2HPW	#4—#8	#2 sol.—#8 sol.	#8 sol.	19/32	0.271	25/32	1-15/32
H1HPW	#2—#8	#1 str.—#8 sol.	#8 sol.	11/16	0.330	7/8	1-5/8
H10HPW	#1—#6	1/0 str.—#6 sol.	#6 sol.	3/4	0.385	15/16	1-13/16
H20HPW	1/0—#6	2/0 str.—#6 str.	#6 sol.	7/8	0.443	1-1/16	2-1/16
H40HPW	4/0—#4	4/0 str.—#4 sol.	#4 sol.	1	0.580	1-5/16	2-15/32

NOTE: Oxide inhibitor recommended when used with aluminum conductors.
For more information, please consult your Thomas & Betts representative.

