

Pipe Straps, Conduit Clamps and Hangers

C-725 — Two-Bolt Pipe Clamp

Designed to suspend cold or hot pipe lines where little or no insulation is required. The C-725 is usually used with an E-120-A Weldless Eyerut or E-157 Welded Eyerod. See Figure 298 heavy-duty Two-Bolt Clamp when higher loads are required. We will also design to meet special requirements such as special pipe sizes.

Rated Loads are for up to 750° F (399° C).

Specifications

- Material: Carbon Steel
- Compliance: Federal Specification A-A-1192A Type 4, MSS-SP-69 Type 4 and BSPSS-BS3974
- Finish: Standard Finish – GoldGalv®, Black (add suffix “-B”), Electro-Galvanized (add suffix “-EG”)
- Ordering: Specify catalog number, finish and pipe size. Also, include any special requirements for C-725

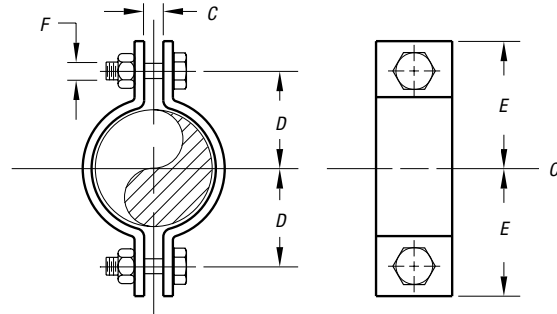

C-726

CAT. NO.	PIPE SIZE (IN.)	MAXIMUM LOAD		C (IN.)	ROD TAKE OUT D (IN.)	E (IN.)	F (IN.)	WT. EACH (LBS.)
		650° F/343° C	750° F/343° C					
C725 1/2	1/2	500	445	3/8	1 1/8	1 1/8	3/8	.31
C-725-3/4	3/4	500	445	3/8	1 1/4	1 3/4	3/8	.35
C-725-1	1	500	445	3/8	1 3/8	1 7/8	3/8	.39
C-725-1-1/4	1 1/4	500	445	3/8	1 7/8	2 1/8	3/8	.40
C-725-1-1/2	1 1/2	800	715	3/8	1 3/4	2 1/4	3/8	.45
C-725-2	2	1,040	930	1/2	2 1/8	2 3/8	1/2	1.23
C-725-2-1/2	2 1/2	1,040	930	5/8	2 3/8	3 1/8	1/2	1.33
C-725-3	3	1,040	930	5/8	3	3 1/2	1/2	1.53
C-725-4	4	1,040	930	3/4	3 3/8	4 1/8	1/2	2.20
C-725-5	5	1,040	930	3/4	4 1/4	5	1/2	2.39
C-725-6	6	1,615	1,440	7/8	5 1/4	6 1/4	3/4	5.87
C-725-8	8	1,615	1,440	1	6 3/8	7 3/8	3/4	6.95
C-725-10	10	2,490	2,220	1	7 3/8	8 3/4	7/8	14.39
C-725-12	12	2,490	2,220	1 1/8	8 3/4	10 1/4	7/8	16.73
C-725-14	14	2,490	2,220	1 1/8	9 1/4	10 3/8	7/8	21.26
C-725-16	16	2,490	2,220	1 1/8	10 1/4	11 1/8	7/8	23.39
C-725-18	18	3,060	2,730	1 1/4	11 1/8	13	1	32.96
C-725-20	20	3,060	2,730	1 3/8	12 3/4	14 1/8	1 1/8	36.74
C-725-24	24	3,060	2,730	1 1/2	15 1/4	16 3/8	1 1/8	52.96
C-725-30	30	3,500	3,360	2	18 1/2	20 3/4	1 1/2	103.50

Standard Finish – GoldGalv®, unless otherwise stated.

Pipe Straps, Conduit Clamps and Hangers

C-726 — Three-Bolt Pipe Clamp

Designed for hot-insulated pipe lines up to 750° F. The spacer on the top inner bolt provides uniform space for the connecting eyerod or weldless eyenut. We will also design to meet special requirements such as special pipe sizes.

Rated Loads are for up to 750° F (399° C).

Specifications

- Material: Carbon Steel
- Federal Specification A-A-1192A Type 3, MSS-SP-69 Type 3 and BSPSS-BS3974
- Finish: Standard Finish – GoldGalv®, Black (add suffix “-B”), Electro-Galvanized (add suffix “-EG”)
- Ordering: Specify catalog number, finish and pipe size. Also, include any special requirements

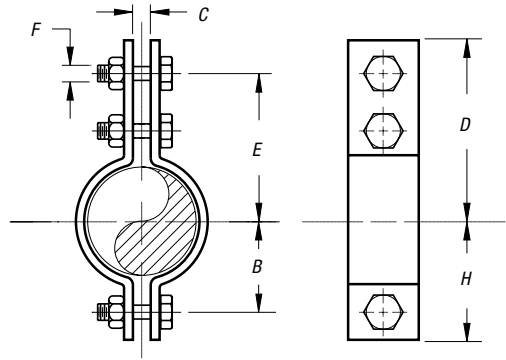

C-726

CAT. NO.	PIPE SIZE (IN.)	MAXIMUM LOAD		B (IN.)	C (IN.)	D (IN.)	TAKE OUT E (IN.)	F (IN.)	H (IN.)	WT. EACH (LBS.)
		650° F/343° C	750° F/399° C							
C-726-1/2	1/2	950	845	1	5/8	2 1/8	2 1/4	3/8	1 3/8	.61
C-726-3/4	3/4	950	845	1 1/8	5/8	3 1/4	2 1/2	3/8	1 3/4	.66
C-726-1	1	950	845	1 1/2	5/8	3 3/4	2 1/2	3/8	2 1/4	.69
C-726-1 1/4	1 1/4	950	845	1 1/2	3/4	3 3/8	2 1/8	3/8	2 1/4	.75
C-726-1-3/4	1 3/4	1,545	1,380	1 3/4	1	4 7/8	4 1/4	5/8	2 1/2	2.14
C-726-2	2	1,545	1,380	2 1/4	1 1/4	5 1/8	5 1/4	5/8	2 3/4	2.43
C-726-2-3/4	2 3/4	1,545	1,380	2 1/4	1 1/4	6 1/4	5 3/8	5/8	3	2.92
C-726-3	3	1,545	1,380	2 3/4	1 1/4	6 5/8	6	5/8	3 1/2	3.19
C-726-4	4	2,500	2,230	3 3/8	1	7 3/8	6 1/2	3/4	4 1/2	7.12
C-726-5	5	2,500	2,230	4	1 1/4	8 1/4	7	3/4	5 1/4	7.96
C-726-6	6	2,865	2,555	4 3/4	1 1/4	9 5/8	8 1/4	7/8	6 1/4	11.85
C-726-8	8	2,865	2,555	5 3/4	1 1/4	10 5/8	9 1/4	7/8	7 1/4	13.59
C-726-10	10	3,240	2,890	6 3/8	1 1/4	12	10 1/2	1	8 1/4	21.33
C-726-12	12	3,240	2,890	8 3/8	1 1/2	13	11 1/2	1	9 5/8	23.65
C-726-14	14	4,300	3,835	9 1/4	2	14 3/8	12 3/4	1 1/4	10 3/4	38.78
C-726-16	16	4,300	3,835	10	2	15 5/8	14	1 1/4	11 1/4	42.89
C-726-18	18	4,300	3,835	11 3/8	2	16 3/4	15 1/4	1 1/4	13 1/4	46.35
C-726-20	20	4,500	4,015	12 3/8	2	17 1/2	15 5/8	1 3/8	14	58.67
C-726-24	24	5,490	4,900	14 3/4	2	19 3/8	17 3/8	1 1/2	16 3/8	89.32
C-726-30	30	7,500	6,690	18 1/2	1 1/2	26 3/8	23 3/8	1 1/2	21	140.89
C-726-36	36	1,0500	9,360	22 1/2	3	32 1/4	28 3/4	1 3/4	26	246.44

Standard Finish – GoldGalv® unless otherwise stated.

Technical Information

Federal Specifications (WW-H-171)/ Manufacturers Society Specifications (MSS SP69)



C-710
Adj. Steel Clevis
Sizes 3/4" through 20" IPS
Federal Type 1
SP69 Type 1



C-726
Steel Double Bolt Pipe Clamp
Sizes 1 1/2" through 24" IPS
Federal Type 3
SP69 Type 3



C-725
Steel Pipe Clamp
Sizes 1 1/2" through 24" IPS
Federal Type 4
SP69 Type 4



CF-710
Adj. Steel Band Hanger
Sizes 1/2" through 8"
IPS 3/4" through 4" tube
Federal Type 7

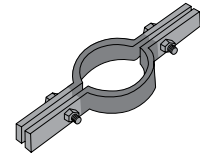

C-720/CT-720
Extension Pipe or Riser Clamp
Sizes 3/4" through 20"
IPS 1/2" through 6" tube
Federal Type 8
SP69 Type 8



C-727/CT-727
Adj. Swivel Ring Hanger
Sizes 1/2" through 8" IPS
1/2" through 4" tube
Federal Type 10
SP69 Type 10

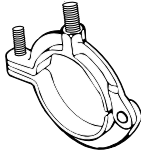

M-718/MT-718
MI Split Pipe Ring
w/wo turnbuckle adj.
Sizes 1/2" through 8" IPS
1/2" through 4" tube
Federal Type 11
SP69 Type 12



CL-710
Light-Duty Clevis Hanger
Sizes 1/2" through 4"
Federal Type 12



F-112
Forged Steel Turnbuckle
Sizes 3/8" through 1 1/2" rod
Federal Type 13
SP69 Type 13



F-111
Forged Steel Clevis
Sizes 3/8" through 1 1/2" rod
Federal Type 14
SP69 Type 13

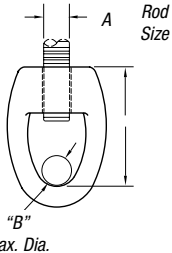

M-117
MI Socket only for
S Split Ring Hanger
Sizes 3/8" through 1 1/2" Rod
Federal Type 16
SP69 Type 16



E-120-A
Forged Steel Weldless Eye Nut
Sizes 3/8" through 1 1/2" rod
Federal Type 17
SP69 Type 17

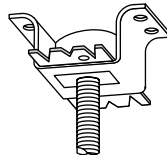

452
Steel Concrete Insert
Federal Type 19
SP69 Type 18

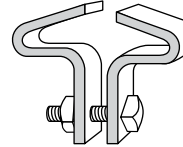

C-755 T/C-757 T
Center I-Beam Clamp
Federal Type 21
SP69 Type 21

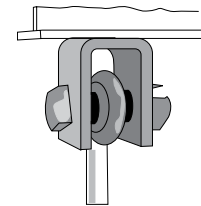

C-780
Welded attachment as
shown or inverted less bolt
Federal Type 22
SP69 Type 22



M-775-L/C-775-L
MI or Steel C-Clamp
Sizes 3/8" through 1 1/2"
Federal Type 23
SP69 Type 23



H-115
U-Bolt
Sizes 1/2" through 24" IPS
Federal Type 24
SP69 Type 24

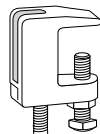

M-778
Top Beam C-Clamp
Sizes 3/8" through 3/4" rod
SP69 Type 19

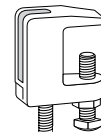

M-777
Junior Top Beam C-Clamp
Sizes 3/8" through 1/2" rod
SP69 Type 18

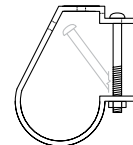

C-711
"J" Pipe Hanger
Sizes 1/2" through 8" pipe
SP69 Type 5