

Pipe Straps, Conduit Clamps and Hangers

C-727-P — PVC-Coated Adjustable Swivel Ring

Designed for the support of non-insulated static pipe lines and to protect the pipe from coming into direct contact with the hanger by having the contact surface PVC coated. The swivel nut is knurled to provide a gripping surface when adjusting the pipe elevation.

Specifications

- Compliance: Federal Specification A-A-1192A Type 10, MSS SP-69 Type 10, UL Listed and FM Approved (¾" through 8")
 - Material: Carbon Steel
 - Finish: Standard Finish — GoldGalv®, Black (add suffix "-B"), Electro-Galvanized (add suffix "-EG")
 - Ordering: Specify pipe size and catalog number
- We also offer Swivel Ring hangers that are for Copper Tubing (CT-727) and for NFPA requirements (C-727-NFPA) in this catalog. Operating temperature should not exceed 140° F/60° C

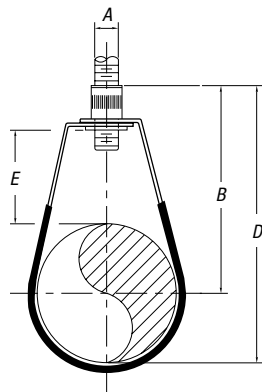

C-727-P

CAT. NO.	PIPE SIZE (IN.)	MAX. LOAD (LBS.)	DIMENSIONS (IN.)				WT. EACH (LBS.)
			A	B	D	E	
C727P 1/2	½	300	¾	2¼	3¼	1¼	.11
C-727-P-3/4	¾	300	¾	2½	3¼	1½	.13
C-727-P-1	1	300	¾	2½	3¼	1	.13
C-727-P-1-1/4	1¼	300	¾	2¾	3¾	1¼	.15
C-727-P-1-1/2	1½	300	¾	3	3¾	1¼	.17
C-727-P-2	2	300	¾	3¼	4¾	1½	.18
C-727-P-2-1/2	2½	600	½	3¾	5¾	1¼	.34
C-727-P-3	3	600	½	4	5¾	1½	.39
C-727-P-3-1/2	3½	600	½	4¾	6¾	1½	.42
C-727-P-4	4	1,000	¾	4¾	7¾	1¼	.48
C-727-P-5	5	1,000	¾	5¾	8¾	1¾	.69
C-727-P-6	6	1,250	¾	6¾	10¾	2	1.13
C-727-P-8	8	1,800	¾	8¾	12¾	2¾	1.29

Standard Finish — GoldGalv®, unless otherwise stated.

C-727-NFPA — NFPA Swivel Ring

Designed for the support of non-insulated static pipe lines. The swivel nut is knurled to provide a gripping surface when adjusting the tubing elevation and is tapped to the reduced rod standards of NFPA.

Specifications

- Compliance: Federal Specification A-A-1192A Type 10, MSS SP-69 Type 10, UL Listed and FM Approved (¾" through 8") and NFPA standards
 - Material: Carbon Steel
 - Finish: Standard Finish — GoldGalv®, Black (add suffix "-B"), Electro-Galvanized (add suffix "-EG")
 - Ordering: Specify pipe size, catalog number and finish
- We also offer Swivel Ring hangers that are for standard commercial pipe (C-727), copper tubing (CT-727) and PVC coated (C-727-P) in this catalog

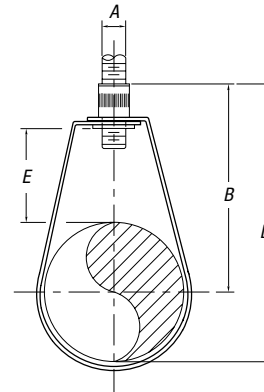

C-727-P

CAT. NO.	PIPE SIZE (IN.)	MAX. LOAD (LBS.)	DIMENSIONS (IN.)				WT. EACH (LBS.)
			A	B	D	E	
C-727-NFPA-1/2	½	300	¾	2¼	3¼	1¼	.09
C-727-NFPA-3/4	¾	300	¾	2½	3¼	1½	.10
C-727-NFPA-1	1	300	¾	2½	3¼	1	.10
C-727-NFPA-1-1/4	1¼	300	¾	2¾	3¾	1¼	.10
C-727-NFPA-1-1/2	1½	300	¾	3	3¾	1¼	.11
C-727-NFPA-2	2	300	¾	3¼	4¾	1½	.12
C-727-NFPA-2-1/2	2½	525	¾	3¾	5	1¼	.25
C-727-NFPA-3	3	525	¾	3¾	5¾	1½	.30
C-727-NFPA-3-1/2	3½	525	¾	4¾	6¾	1½	.33
C-727-NFPA-4	4	650	¾	4¾	7	1¾	.41
C-727-NFPA-5	5	1,000	½	5¾	8¾	2¼	.58
C-727-NFPA-6	6	1,000	½	6¾	9¾	2¼	.92
C-727-NFPA-8	8	1,000	½	7¾	12¼	2¾	1.16

Standard Finish — GoldGalv®, unless otherwise stated.