

## C-Tap Connectors for Copper Conductor

Easy to work with in tight spaces.

### C-Taps — Large Size for 600V Applications

- More economical than other taps and split bolts in terms of purchase, inventory, installation time, insulation and maintenance
- Color-coded for easy matching with proper die
- Barely larger than conductor insulation once installed

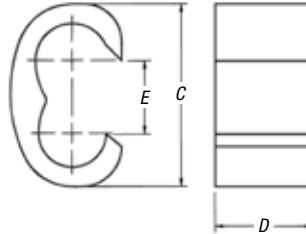

**Material:** High-Conductivity Wrought Copper

**Finish:** Plain



CAT. NO.	WIRE SIZE		DIMENSIONS (IN.)			INSTALLING DIE		DIE CODE	NO. OF CRIMPS	COLOR KEY
	MAIN	BRANCH	C	D	E	TOOL	CAT. NO.			
54755	#1 AWG	#1 AWG	1 <sup>15</sup> / <sub>16</sub>	¾	1 <sup>1</sup> / <sub>32</sub>	TBM14M	15512	76	1	BLUE
	1/0 AWG	1/0-#2 AWG				TBM15I	15512*	76		
	2/0 AWG	2/0-#4 AWG				TBM12	TBM12D-4	76		
	3/0 AWG	1/0-#6 AWG				13100A	15512	76		
54760	4/0 AWG	#1-#8 AWG	1 <sup>1</sup> / <sub>6</sub>	¾	1 <sup>9</sup> / <sub>32</sub>	TBM14M	15506	87H	2	BROWN
	2/0 AWG	2/0-#1 AWG				TBM15I	15506*	87H		
	3/0 AWG	3/0-#3 AWG				TBM12	TBM12D-3	87H		
	4/0 AWG	4/0-#4 AWG				13100A	15506	87H		
54765	250 kcmil	#1-#8 AWG	1 <sup>1</sup> / <sub>6</sub>	1	4 <sup>1</sup> / <sub>64</sub>	TBM14M	15505	99H	2	PINK
	2/0 AWG	2/0-#1 AWG				TBM15I	15505*	99H		
	3/0 AWG	3/0-#2 AWG				TBM12	TBM12D-2	99H		
	4/0 AWG	4/0-#4 AWG				13100A	15505	99H		
54770	250 kcmil	3/0-#6 AWG	1 <sup>1</sup> / <sub>6</sub>	1	1 <sup>1</sup> / <sub>6</sub>	TBM14M	15515	106H	2	BLACK
	300 kcmil	2/0-#8 AWG				TBM15I	15515*	106H		
	4/0 AWG	4/0-2/0 AWG				TBM12	TBM12D-2	106H		
	350 kcmil	250 kcmil-#1 AWG				13100A	15515	106H		
54775**	250 kcmil	250 kcmil	1 <sup>7</sup> / <sub>8</sub>	1 <sup>1</sup> / <sub>4</sub>	1 <sup>1</sup> / <sub>16</sub>	TBM14M	15504	115H	2	YELLOW
	300 kcmil	300 kcmil-3/0 AWG				TBM15I	15504*	115H		
	350 kcmil	350 kcmil-1/0 AWG				TBM12	TBM12D-1	115H		
	400 kcmil	300 kcmil-#2 AWG				13100A	15504	115H		
	450 kcmil	250 kcmil-#4 AWG								
54780	500 kcmil	250 kcmil-#6 AWG	2 <sup>3</sup> / <sub>16</sub>	1 <sup>1</sup> / <sub>4</sub>	5 <sup>3</sup> / <sub>64</sub>	TBM14M	15504	115H	2	N/A
	350 kcmil	350 kcmil-4/0 AWG				TBM15I	15603	125H		
	400 kcmil	400 kcmil-2/0 AWG								
	450 kcmil	450 kcmil-#1 AWG								
500 kcmil	500 kcmil-#2 AWG									
54785	750 kcmil	4/0-#6 AWG	2 <sup>1</sup> / <sub>8</sub>	2	1	TBM15I	15603	125H	3	
54790	750 kcmil	750 kcmil-4/0 AWG	2 <sup>11</sup> / <sub>16</sub>	2	1 <sup>1</sup> / <sub>6</sub>	TBM15I	15603	125H	3	

UL approved for direct burial.

For covers, see p. F-48

Taps can be supplied tin-plated. Add suffix "TP" to any catalog number (i.e., 54725TP).

\* Cat. No. 15500-TB adapter required if using TBM15I and 155XX series dies.

\*\* #6 AWG branch must be doubled.

Tooling: pp. F-80-F-100

Die Selector Chart: p. F-101-F-104