

C-Tap Connectors for Copper Conductor

Easy to work with in tight spaces.

C-Taps — Large Size for 600V Applications

- More economical than other taps and split bolts in terms of purchase, inventory, installation time, insulation and maintenance
- Color-coded for easy matching with proper die
- Barely larger than conductor insulation once installed

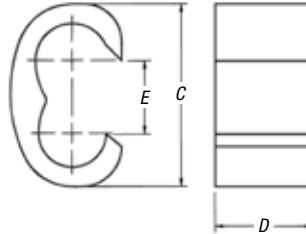

Material: High-Conductivity Wrought Copper

Finish: Plain



CAT. NO.	WIRE SIZE		DIMENSIONS (IN.)			INSTALLING DIE		DIE CODE	NO. OF CRIMPS	COLOR KEY
	MAIN	BRANCH	C	D	E	TOOL	CAT. NO.			
54755	#1 AWG	#1 AWG	1 ¹⁵ / ₁₆	¾	1 ¹ / ₃₂	TBM14M	15512	76	1	BLUE
	1/0 AWG	1/0-#2 AWG				TBM15I	15512*	76		
	2/0 AWG	2/0-#4 AWG				TBM12	TBM12D-4	76		
	3/0 AWG	1/0-#6 AWG				13100A	15512	76		
54760	4/0 AWG	#1-#8 AWG	1 ¹ / ₆	¾	1 ⁹ / ₃₂	TBM14M	15506	87H	2	BROWN
	2/0 AWG	2/0-#1 AWG				TBM15I	15506*	87H		
	3/0 AWG	3/0-#3 AWG				TBM12	TBM12D-3	87H		
	4/0 AWG	4/0-#4 AWG				13100A	15506	87H		
54765	250 kcmil	#1-#8 AWG	1 ¹ / ₆	1	4 ¹ / ₆₄	TBM14M	15505	99H	2	PINK
	2/0 AWG	2/0-#1 AWG				TBM15I	15505*	99H		
	3/0 AWG	3/0-#2 AWG				TBM12	TBM12D-2	99H		
	4/0 AWG	4/0-#4 AWG				13100A	15505	99H		
54770	250 kcmil	3/0-#6 AWG	1 ¹ / ₆	1	1 ¹ / ₆	TBM14M	15515	106H	2	BLACK
	300 kcmil	2/0-#8 AWG				TBM15I	15515*	106H		
	4/0 AWG	4/0-2/0 AWG				TBM12	TBM12D-2	106H		
	350 kcmil	250 kcmil-#1 AWG				13100A	15515	106H		
54775**	250 kcmil	250 kcmil	1 ⁷ / ₈	1 ¹ / ₄	1 ¹ / ₁₆	TBM14M	15504	115H	2	YELLOW
	300 kcmil	300 kcmil-3/0 AWG				TBM15I	15504*	115H		
	350 kcmil	350 kcmil-1/0 AWG				TBM12	TBM12D-1	115H		
	400 kcmil	300 kcmil-#2 AWG				13100A	15504	115H		
	450 kcmil	250 kcmil-#4 AWG								
54780	500 kcmil	250 kcmil-#6 AWG	2 ³ / ₁₆	1 ¹ / ₄	5 ³ / ₆₄	TBM14M	15504	115H	2	N/A
	350 kcmil	350 kcmil-4/0 AWG				TBM15I	15603	125H		
	400 kcmil	400 kcmil-2/0 AWG								
	450 kcmil	450 kcmil-#1 AWG								
500 kcmil	500 kcmil-#2 AWG									
54785	750 kcmil	4/0-#6 AWG	2 ¹ / ₈	2	1	TBM15I	15603	125H	3	
54790	750 kcmil	750 kcmil-4/0 AWG	2 ¹¹ / ₁₆	2	1 ¹ / ₆	TBM15I	15603	125H	3	

UL approved for direct burial.

For covers, see p. F-48

Taps can be supplied tin-plated. Add suffix "TP" to any catalog number (i.e., 54725TP).

* Cat. No. 15500-TB adapter required if using TBM15I and 155XX series dies.

** #6 AWG branch must be doubled.

Tooling: pp. F-80-F-100

Die Selector Chart: p. F-101-F-104

Tools and Dies

Dies for Standard Lugs & Splices (TBM45S – TBM12)

CONNECTOR SIZE				TBM8-750M-1 TBM8-750BSCR TBM8-750			TBM-8/8S	TBM-5/5S	TBM6/6S / 25000		13642M / 13400 HYDRAULIC HEAD		TBM12 HYDRAULIC HEAD	
CODE COPPER	FLEX/24	AL/CU	COLOR CODE	TBM45S	TBM4S	TBM8-750	TBM8 DIE CAT. NO.	TBM5 DIE CAT. NO.	CAT. NO. UPPER DIE	CAT. NO. LOWER DIE	DIE CAT. NO.	DIE CODE NO.	DIE CAT. NO.	DIE CODE NO.
#8 AWG	37/24	10 AWG	RED	C-Taps Only	↕	↕	13461	13454	13475	13477	11732	21	TBM12D-1	21
#6 AWG	61/24	#8 AWG	BLUE						13475	13477	11733	24	TBM12D-1	24
#4 AWG	91/24	#6 AWG	GRAY						13472	13476	11734	29	TBM12D-2	29
#2 AWG	125/24		BROWN						13474	13477	11735	33	TBM12D-2	33
#1 AWG	150/24	#4 AWG	GREEN						13474	13477	11736	37	TBM12D-3	37
1/0 AWG	225/24	#2 AWG	PINK						13475	13477	11737	42	TBM12D-3	42
2/0 AWG	275/24		BLACK						13474	13477	11738	45	TBM12D-4	45
3/0 AWG	325/24		ORANGE						13474	13477	11739	50	TBM12D-4	50
4/0 AWG	450/24		PURPLE						13475	13477	11740	54	TBM12D-5	54
250 kcmil	550/24		YELLOW						13473	13476	11771	62	TBM12D-5	62
		#1 AWG	GOLD	13474	13477	11738	45	TBM12D-4	45					
		1/0 AWG	TAN	13474	13477	11739	50	TBM12D-4	50					
		2/0 AWG	OLIVE	13475	13477	11740	54	TBM12D-5	54					
		3/0 AWG	RUBY	13473	13476	11741	60	TBM12D-5	60					
300 kcmil		4/0 AWG	WHITE	13465		13473	13476	11742	66H	TBM12D-5	66H			
350 kcmil	775/24	250 kcmil	RED	13466		13472	13476	11743	71H	TBM12D-4	71H			
	(short)													
400 kcmil	775/24	300 kcmil	BLUE	13467	4/0 only	13472	13476	11744	76H	TBM12D-4	76H			
	(long)													
	925/24*		N/A			13479	13476	11745	80H					
			N/A											
500 kcmil		350 kcmil	BROWN	13468		13478	13478	11746-TB	87H	TBM12D-3	87H			
600 kcmil	1100/24	400 kcmil	GREEN					11747	94H	TBM12D-3	94H			
			GREEN								94H			
	1325/24**		PINK											
700 kcmil		500 kcmil	PINK					11748	99H	TBM12D-2	99H			
750 kcmil		650 kcmil	BLACK					11749	106H	TBM12D-2	106H			
800 kcmil			ORANGE					11750	107H					
		700 kcmil	PURPLE					11751	112H	TBM12D-1	112H			
900 kcmil	1925/25	750 kcmil	YELLOW					11753	115H	TBM12D-1	115H			
1000 kcmil		800 kcmil												
		1000 kcmil												

* Standard barrel only. Long barrel requires Brown 87H.

** Standard barrel only. Long barrel requires Brown 106H.

Dies for Standard Lugs & Splices (OD58)

CONNECTOR SIZE				OD58	
CODE COPPER	FLEX/24	AL/CU	COLOR CODE	DIE CAT NO.	DIE CODE NO.
#8 AWG	37/24	#10 AWG	RED	BY15C	21
#6 AWG	61/24	#8 AWG	BLUE	BY17C	24
#4 AWG	91/24	#6 AWG	GRAY	BY19C	29
#2 AWG	125/24		BROWN	BY21C	33
#1 AWG	150/24	#4 AWG	GREEN	BY53C	37
1/0	225/24	#2 AWG	PINK	BY23C	42
2/0	275/24		BLACK	BY28C	45
3/0	325/24		ORANGE	BY25C	50
4/0	450/24		PURPLE	BY27C	54
250 kcmil	550/24		YELLOW	BY31C	62
		#1 AWG	GOLD	BY24C	45
		1/0	TAN	BY25C	50
		2/0	OLIVE	BY31C	54
		3/0	RUBY	BY32C	60