

Accessories



CISBEX



CIXCUBE



CISBEX-HV

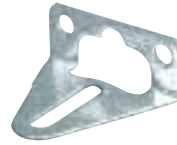

CI1SCREAR/SCR



CI2SCREAR/SCR



| Cat. No.                     | Description  |
|------------------------------|--|
| <b>Device Box Extensions</b> |  |
| <b>CISBEX</b>                | 2 in. x 3 in. switch box extension. Maximum adjustable depth is 7/8 in. Complete with mounting screws  |
| <b>CISBEX-HV</b>             | 2 in. x 3 in. switch box extension. High voltage (347V) for use with CI1204-HV Series. Maximum adjustable depth is 7/8 in. Complete with mounting screws |
| <b>CIXCUBE</b>               | Adds 5.5 cu. in. to any 2-1/2 in. deep gangable device box. Provision for external nailing   |
| <b>Ground Screws</b>         |  |
| <b>GS-1-IB</b>               | 8-32 x 5/16 in. large combination head screw   |
| <b>CI1SCREAR/SCR</b>         | Box ear and screw only, one hole model   |
| <b>CI2SCREAR/SCR</b>         | Box ear and screw only, two hole model   |



CI66



CI66-FPP



CI66-PPH



CI66-SS



CI66-XL



| Cat. No.                      | Dimensions    |
|-------------------------------|---------------|
|                               | W x H (in.)   |
| <b>Cable Protector Plates</b> |               |
| <b>CI66</b>                   | 1-3/8 x 3     |
| <b>CI66-FPP</b>               | 2-3/8 x 3-1/2 |
| <b>CI66-PPH</b>               | 1-1/4 x 3     |
| <b>CI66-SS</b>                | 4-3/8 x 1-7/8 |
| <b>CI66-XL</b>                | 4-1/4 x 3-3/4 |
| <b>CI66-XL-2</b>              | 8-1/2 x 3-3/4 |
| <b>CI66-T</b>                 | 4-1/4 x 3/4   |

In accordance with C.E.C., 2012 Edition, rule 12-516



CI66-XL-2



CI66-T