

Liquidtight Conduit

Malleable Iron Fittings



- Heavy duty malleable iron
- Zinc electroplated for corrosion resistance
- Tapered threaded hub complete with flange gasket and steel locknut
- Temperature range: -25°C to 90°C

CI6103 (-IT) / CI6116 (-IT)



IT: with insulated throat

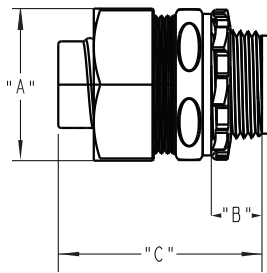

CI6303 (-IT) / CI6316 (-IT)



IT: with insulated throat

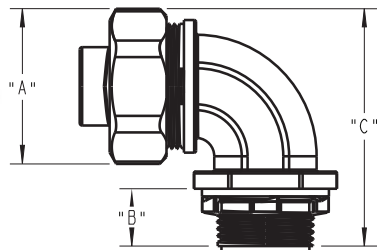

LT-450 / LT-453



Cat. No.	Trade Size (in.)	KO Size (in.)	Dimensions (in.)		
			A	B	C
Straight Liquidtight Fittings (Steel)					
CI6103*	3/8	1/2	1-1/16	9/16	1-5/8
CI6104*	1/2	1/2	1-3/16	9/16	1-3/4
CI6106*	3/4	3/4	1-7/16	9/16	1-5/16
CI6108*	1	1	1-11/16	11/16	2-3/16
CI6110*	1-1/4	1-1/4	2-1/8	11/16	2-3/8
CI6112*	1-1/2	1-1/2	2-3/8	11/16	2-9/16
CI6116*	2	2	2-15/16	13/16	2-3/4
Straight Liquidtight Fittings – Insulated Throat (Malleable Iron)					
CI6103-IT*	3/8	1/2	1-1/16	9/16	1-5/8
CI6104-IT*	1/2	1/2	1-3/16	9/16	1-3/4
CI6106-IT*	3/4	3/4	1-7/16	9/16	1-5/16
CI6108-IT*	1	1	1-11/16	11/16	2-3/16
CI6110-IT*	1-1/4	1-1/4	2-1/8	11/16	2-3/8
CI6112-IT*	1-1/2	1-1/2	2-3/8	11/16	2-9/16
CI6116-IT*	2	2	2-15/16	13/16	2-3/4
90° Liquidtight Fittings (Malleable Iron)					
CI6303*	3/8	1/2	1-1/16	9/16	2
CI6304*	1/2	1/2	1-3/16	9/16	2-1/16
CI6306*	3/4	3/4	1-7/16	9/16	2-1/2
CI6308*	1	1	1-11/16	11/16	2-15/16
CI6310*	1-1/4	1-1/4	2-1/8	11/16	3-5/16
CI6312*	1-1/2	1-1/2	2-3/8	11/16	3-1/2
CI6316*	2	2	2-15/16	13/16	4-5/16
90° Liquidtight Fittings – Insulated Throat (Malleable Iron)					
CI6303-IT*	3/8	1/2	1-1/16	9/16	2
CI6304-IT*	1/2	1/2	1-3/16	9/16	2-1/16
CI6306-IT*	3/4	3/4	1-7/16	9/16	2-1/2
CI6308-IT*	1	1	1-11/16	11/16	2-15/16
CI6310-IT*	1-1/4	1-1/4	2-1/8	11/16	3-5/16
CI6312-IT*	1-1/2	1-1/2	2-3/8	11/16	3-1/2
CI6316-IT*	2	2	2-15/16	13/16	4-5/16
45° Liquidtight Fittings (Malleable Iron)					
LT-450	3/8	1/2	1-1/16	1/2	1-9/16
LT-451	1/2	1/2	1-3/16	1/2	1-5/8
LT-452	3/4	3/4	1-7/16	9/16	7/8
LT-453	1	1	1-3/4	5/8	2-1/8
45° Liquidtight Fittings - Insulated Throat (Malleable Iron)					
LT-950	3/8	1/2	1-1/16	1/2	1-9/16
LT-951	1/2	1/2	1-3/16	1/2	1-5/8
LT-952	3/4	3/4	1-7/16	9/16	1-7/8
LT-953	1	1	1-3/4	5/8	2-1/8