

## Armoured Cable / Flexible Conduit

### Connectors



CI70



Zinc Die Cast Locknut

L-16

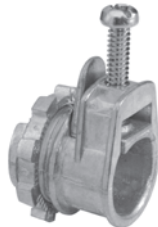

Zinc Die Cast Locknut

CI71 / CI73



Zinc Die Cast Locknut

CI2175



Zinc Die Cast Locknut

CI2275 **New**



Zinc Die Cast Locknut

CI2210 / CI2236



Zinc Die Cast Locknut

CI2238 / CI2240



Zinc Die Cast Locknut

CI4090



Zinc Locknut

Cat. No.	Trade Size (in.)	Clamping Range (in.)		Suggested Application AC90 (BX)	Flex. Conduit
		Min.	Max.		
<b>One Screw Fittings (Zinc Alloy)</b>					
L-16	3/8	0.12	0.63	14/2-10/2-14/3-10/3-14/4-10/4	5/16-3/8
CI70	3/8	0.13	0.70	14/2, 12/2, 10/2, 14/3, 12/3, 10/3, 14/4	3/8
CI71	1/2	0.33	0.95	14/2-10/2; 14/3-10/3; 14/4-8/4	5/16, 3/8, 1/2
CI72	3/4	0.60	1.15	6/2; 8/3-3/3; 8/4-3/4	1/2, 3/4
CI73	1	0.93	1.47	3/3-3/0/3; 2/4-1/4	3/4, 1
<b>Duplex Fitting (Zinc Alloy)</b>					
CI2175	3/8	0.15	0.65	14/2-10/2; 14/3-10/3; 14/4-12/4	3/8
CI2275* <b>New</b>	3/8	0.45	0.58	14/2-10/2; 14/3-10/3; 14/4-12/4	3/8
<b>90° Fittings (Zinc Alloy)</b>					
CI2210	3/8	0.40	0.63	14/2-10/2; 14/3-10/3 14/4-12/4	3/8
CI2211	1/2	0.65	0.97	8/2; 8/3; 10/4	1/2
CI2214	3/4	0.77	1.12	1/0/1-4/0/1; 6/2-4/2; 8/3-3/3; 8/4-6/4	3/4
CI2216	1	1.06	1.40	4/0/1-350/1; 2/2; 4/3-2/3; 6/4-4/4	1
CI2218	1-1/4	1.34	1.65	500/1-750/1; 1/3-3/0/3; 1/4-1/0/4	1-1/4
CI2234	1-1/2	1.70	2.15	600/1-1000/1; 2/0/3; 1/4-3/0/4	1-1/2
CI2236	2	1.51	2.47	600/1-1000/1; 2/0/3-400/3; 1/4-4/0/4	1-1/2 - 2
CI4090	4	4.17	4.62	—	4
<b>90° Fittings (Aluminum)</b>					
CI2238	2-1/2	2.50	3.08	600/3-750/3	2-1/2
CI2240	3	2.95	3.55	1000/3	3

Also suitable for ACWU90 (of equivalent diameters) in dry locations. A non-ferrous connector and locknut must be used to terminate a single conductor cable when nominal current exceeds 200 A.

\* Suitable for AC90 and ACG90: Clamping range for AC90 is 0.45–0.58 and for ACG90 is 0.47–0.57.

**NOTE:** 3/8 in. trade size fittings require a 1/2 in. knockout

Technical improvements are constantly taking place in the electrical industry. Cable manufacturers are changing their products from time to time. Accordingly, it is strongly suggested that you verify the cable size with the cable manufacturer prior to selecting a fitting. See specification guide section for dimensions (D38-D39).

## Specification Guide

### Cable Connectors



CI2210 / CI2236

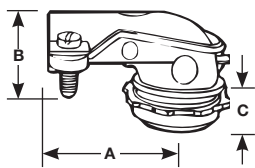

CI2238 / CI2240

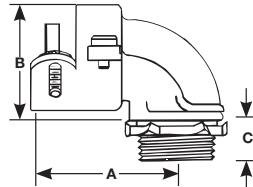

CI3360

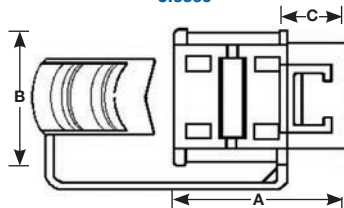

CI4004

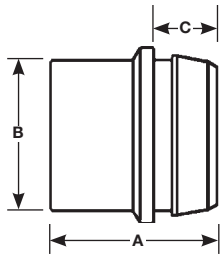

CI4000

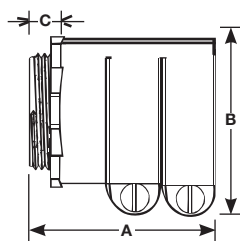

CI4090

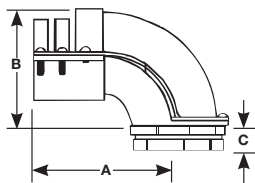

CI4040

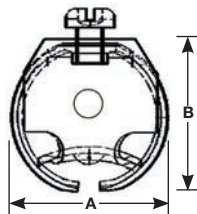

CI9049

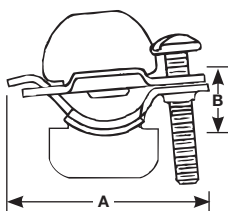

Cat. No.	Trade Size	Clamping Range		Dimensions		
		Min.	Max.	A	B	C
<b>90° Connectors (Zinc Alloy)</b>						
CI2210	3/8	0.40	0.63	1-3/8	3/4	3/8
CI2211	1/2	0.65	0.97	1-11/16	1-1/16	3/8
CI2214	3/4	0.77	1.12	1-3/4	1-1/8	1/2
CI2216	1	1.10	1.57	2	1-5/8	5/8
CI2218	1-1/4	1.27	1.75	3-3/8	2-1/8	5/8
CI2234	1-1/2	1.70	2.15	5-1/4	3-1/4	3/4
CI2236	2	2.00	2.62	5-3/8	3-1/4	3/4
CI4090	4	4.17	4.62	8-1/4	6	1
<b>90° Connectors (Aluminum)</b>						
CI2238	2-1/2	2.50	3.08	6-1/4	5-1/2	3/4
CI2240	3	2.95	3.55	7-1/4	6-5/8	3/4
<b>Nonmetallic Connector</b>						
CI3360	1/2	0.30	0.60	1-5/16	1-1/16	7/16
<b>Two Screw Connector (Aluminum)</b>						
CI4000	4	4.40	4.55	4-7/8	5-3/4	7/8
<b>Nonmetallic Connector</b>						
CI4004	1/2	0.21	0.42	15/16	7/8	3/8
<b>One Screw Connectors (Steel)</b>						
CI4040	3/8	0.19	0.57	15/16	7/8	—
CI9049	3/8	0.13	0.37	1-3/8	5/16	—

Technical improvements are constantly taking place in the electrical industry. Cable manufacturers are changing their products from time to time. Accordingly, it is strongly suggested that you verify the cable size with the cable manufacturer prior to selecting a fitting.