

# 5507 SERIES™ FACEPLATES

## Ordering Information



5507 Series™ Faceplates accept a wide assortment of power, A/V and datacom devices from leading manufacturers. Faceplates can be used in nonmetallic device brackets for 2300BACD, 400BAC, 5000, 5400TB, 5500BD3, 40N2 Series Raceways, 4050 Device Bracket for Steel Raceways, and WallSource™ Boxes.

**NOTE:** All 5507 Series™ Faceplates have a standard measurement of 4 1/4" x 1 7/8" [108mm x 34mm].

### CODE REFERENCE

**Listed Raceway:**

File E90378 Guide RJTX.

Complies with flammability requirements of UL-5A.

**Fittings:** File E90377 Guide RJYT.

Meets Article 388 of NEC.

UL Listed for up to 600V.

Meets Section 12-1600 of CEC.

### COLOR OPTIONS



5507 Series™ faceplate Part Numbers without a suffix are available in an ivory finish. Part Numbers with a "-WH" suffix have a white finish. Part Numbers with a "-G" suffix have a gray finish. Part Numbers with a "-BK" suffix have a black finish. Part Numbers with a "-FW" suffix have a fog white finish. Part numbers with a "-GY" suffix have a light gray finish.

### 5507 Series Faceplates Ordering Information

#### 5507AD Modular Furniture Adapter

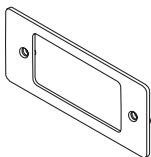

For mounting Activate and other modular furniture bezels and other modular furniture adapters. Not for use with rectangular (decorator) style devices. Available in ivory (5507AD), white (5507AD-WH), gray (5507AD-G) and fog white (5507AD-FW).

#### 5507D Duplex Receptacle Faceplate

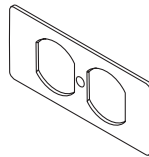

For covering duplex style devices. Accepts 106 Frame. Available in ivory (5507D), white (5507D-WH), gray (5507D-G), black (5507D-BK), light gray (5507D-GY) and fog white (5507D-FW).

#### 5507B Blank Faceplate

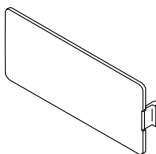

For covering unused compartments in the device bracket. Available in ivory (5507B), white (5507B-WH), gray (5507B-G), light gray (5507B-GY) and fog white (5507B-FW).

#### 5507FRJ Flush Dual RJ Connector Faceplate

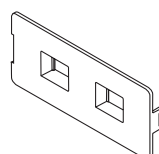

For mounting one or two keystone device modules, recessed to provide a flush installation. Has one opening and one KO. Available in ivory (5507FRJ), white (5507FRJ-WH), gray (5507FRJ-G), light gray (5507FRJ-GY) and fog white (5507FRJ-FW).

## 5507 SERIES™ FACEPLATES

## Ordering Information

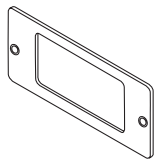
**5507R Rectangular Receptacle Faceplate**

For covering rectangular decorator style devices. Available in ivory (5507R), white (5507R-WH), gray (5507R-G) and fog white (5507R-FW).

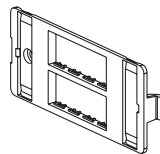
**5507-4TJ Ortronics® Faceplate**

For mounting Ortronics® datacom inserts. Accepts four TracJack devices. Available in ivory (5507-4TJ), white (5507-4TJ-WH), gray (5507-4TJ-G) and fog white (5507-4TJ-FW).

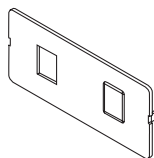
**5507RJ Dual RJ11/RJ45 Connector Faceplate**

For mounting one or two keystone device modules. Has one opening and one KO. Available in ivory (5507RJ), white (5507RJ-WH), gray (5507RJ-G), light gray (5507RJ-GY) and fog white (5507RJ-FW).

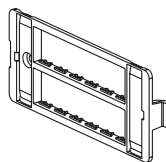
**5507-6TJ Ortronics® Faceplate**

For mounting Ortronics® datacom inserts. Accepts six TracJack devices. Available in ivory (5507-6TJ), white (5507-6TJ-WH), gray (5507-6TJ-G) and fog white (5507-6TJ-FW).

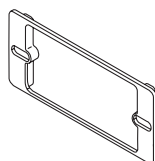
**5507S Rectangular Spacer**

For mounting commercial device plates. Installs between the device bracket and a device. Available in ivory (5507S), white (5507S-WH), black (5507S-BK), fog white (5507S-FW), light gray (5507S-GY) and gray (5507S-G).

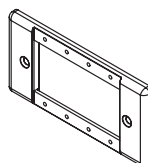
**5507MAAP Extron® MAAP Faceplate**

Accepts four AVIP and Extron® Electronics MAAP single space modules. Available in ivory (5507MAAP), white (5507MAAP-WH), gray (5507MAAP-G), black (5507MAAP-BK), light gray (5507MAAP-GY) and fog white (5507MAAP-FW).

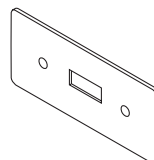
**5507SW Switch Faceplate**

For covering standard toggle switches. Available in ivory (5507SW), white (5507SW-WH), gray (5507SW-G) and fog white (5507SW-FW).

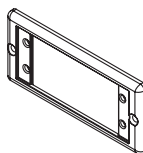
**5507AAP Extron® AAP Faceplate**

Accepts two Extron® Electronics AAP single space modules. Available in ivory (5507AAP), white (5507AAP-WH), gray (5507AAP-G), black (5507AAP-BK), light gray (5507AAP-GY) and fog white (5507AAP-FW).

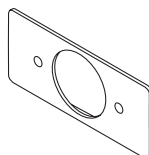
**5507T1 Single Receptacle Faceplate**

For covering single receptacles 1.59" [40mm] diameter. Available in ivory (5507T1), white (5507T1-WH), gray (5507T1-G) and fog white (5507T1-FW).

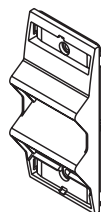
**ARA-S2 Angled Raceway Adapter**

Provides angled exit in multi-channel raceway systems. Snaps into standard 4050, 5450, 5450T, 5550, 40N2F31 and WallSource Device Brackets. Angled exit provides additional mounting depth required for A/V connections as well as ensuring the required bend radius for UTP and fiber optic cabling. Holds two Ortronics® Series II modules. Fits 5507 Series Faceplate opening. Available in ivory (ARA-S2-IV), fog white (ARA-S2-FW), black (ARA-S2 -BK), gray (ARA-S2-G), light gray (ARA-S2-GY) and white (ARA-S2-WH).

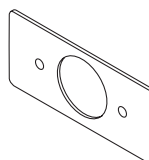
**5507T2 Single Receptacle Faceplate**

For covering single receptacles 1.41" [36mm] diameter. Available in ivory (5507T2), white (5507T2-WH), gray (5507T2-G) and fog white (5507T2-FW).