

RESOURCE RFB® SERIES FLOOR BOXES

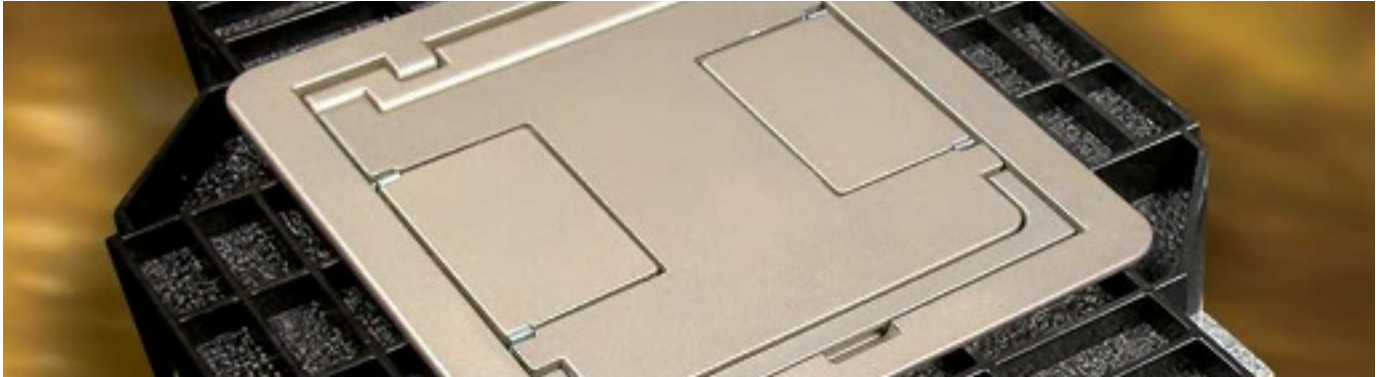

Resource RFB® Series Floor Boxes are a versatile solution that provides power and/or communication services to open space areas.

CODE REFERENCE

cULus Listed
Metallic Outlet Boxes:
 File E2961 Guide QCIT.
 Meets Article 314.27(C) of NEC.

RFB2 Series Multiservice Steel Recessed Floor Boxes Ordering Information

RFB2-SS Two-Compartment Shallow Stamped Steel Box

For use in either concrete or wood floors. Fully adjustable with tunnel compartment. Supplied with one (1) duplex receptacle mounting plate, and one (1) communication mounting plate (RFB22AB). Other device plates sold separately.

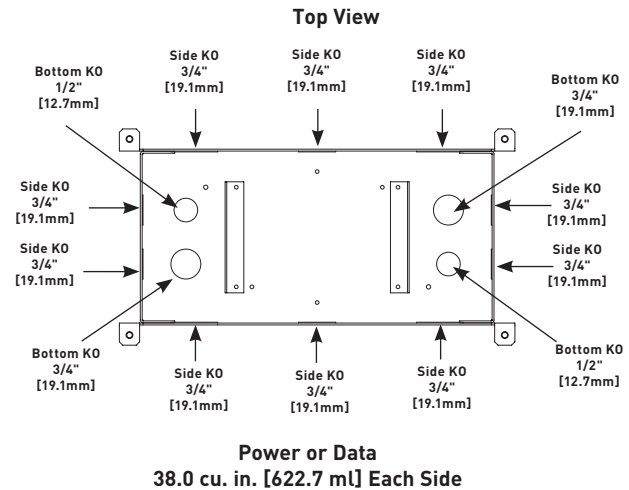
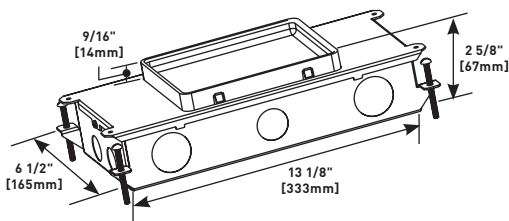

RESOURCE RFB® SERIES FLOOR BOXES

RFB6 Series

RFB6 & RFB6E Series Steel Recessed Floor Boxes Ordering Information

RFB6DP Internal Duplex Receptacle Bracket

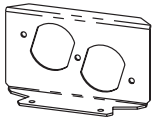

Accepts standard 15A and 20A duplex receptacles.

NOTE: For RFB4E, RFB6 and RFB6E Series Floor Boxes.

RFB6RT Internal Communication Bracket

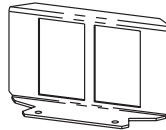

Includes one (1) adapter to accept Ortronics® TracJack devices, and one (1) adapter to accept Ortronics Series II devices (sold separately).

NOTE: For RFB4E, RFB6 and RFB6E Series Floor Boxes.

RFB6B Internal Blank Bracket

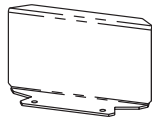

Closes off unused gangs.

NOTE: For RFB4E, RFB6 and RFB6E Series Floor Boxes.

RFB6EXT Internal A/V Bracket

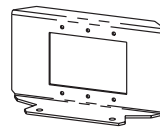

Accepts three (3) Legrand AVIP or Extron® Electronics MAAP Series devices (sold separately).

NOTE: For RFB4E, RFB6 and RFB6E Series Floor Boxes.

RFB6GFI Internal GFI or Decorator Style Receptacle Bracket

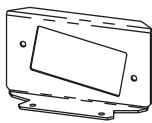

Accepts standard GFCI and Decorator Style receptacles, communication or A/V devices.

NOTE: For RFB4E, RFB6 and RFB6E Series Floor Boxes.

RFB62A Internal Communication Bracket

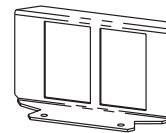

Includes two (2) adapters to accept Wiremold CM2 Series Open System communication inserts (sold separately).

NOTE: For RFB4E, RFB6 and RFB6E Series Floor Boxes.

RFB6S1 Internal Single Receptacle Bracket

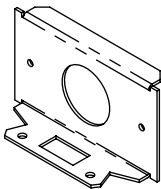

Receptacle opening 1 3/8" [35mm].

NOTE: For RFB4E, RFB6 and RFB6E Series Floor Boxes.

RFB6-AAP Internal A/V Bracket

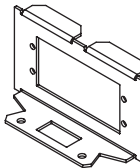

Accepts two (2) Extron® Electronics AAP Series devices (sold separately).

NOTE: For RFB4E, RFB6 and RFB6E Series Floor Boxes.

RFB6S2 Internal Single Receptacle Bracket

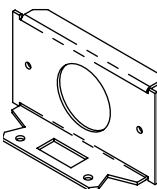

Receptacle opening 1 9/16" [40mm].

NOTE: For RFB4E, RFB6 and RFB6E Series Floor Boxes.

RFB6E-CTR Bare Concrete & Terrazzo Ring

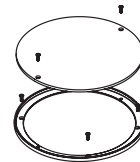

Nonmetallic ring for use with bare concrete and terrazzo floor applications.

NOTE: For RFB4E, RFB6 and RFB6E Series Floor Boxes. Designed to work with 8CTC and 8CT Series Covers only.

FP-CTR Bare Concrete & Terrazzo Ring

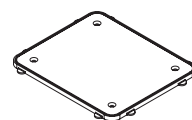

Nonmetallic ring for use on bare polished concrete and terrazzo floor applications.

NOTE: For RFB6 Series Floor Boxes.