

6000® SERIES RACEWAY



6000 Series Raceway is ideal for all applications requiring high cable capacity.

CODE REFERENCE

cULus Listed Raceway:
File E4376 Guide RJBT.

Fittings:
File E41751 Guide RJPR.
Meets Article 386 of NEC.
Meets Section 12-1600 of CEC.

System Layout

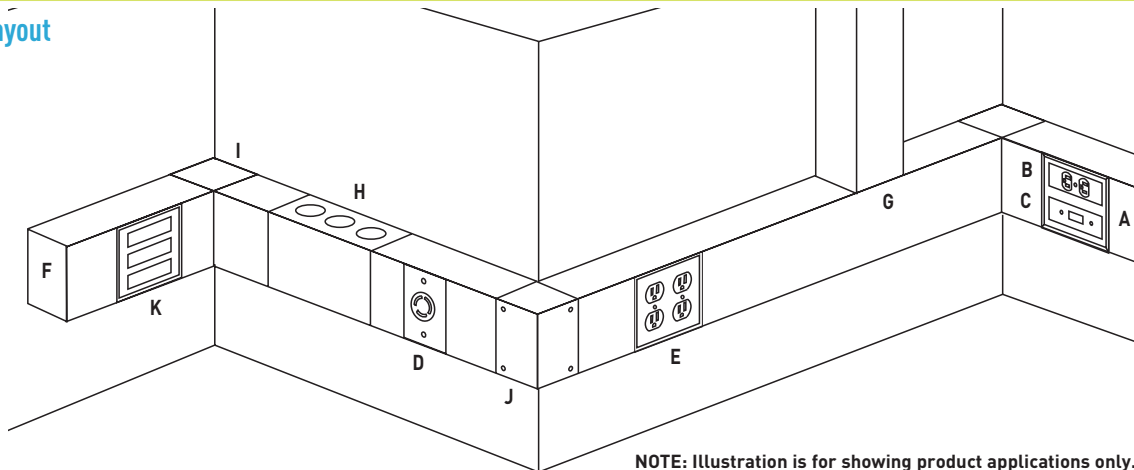

NOTE: Illustration is for showing product applications only.

KEY

- | | |
|---|--|
| A. 4050 Device Mounting Plate
Inserts included | G. 6011TX Combination Flat Elbow |
| B. 5507D Duplex Receptacle Faceplate | H. 6014A Connector Fitting |
| C. 5507SW Switch Faceplate | I. 6017TX Combination Internal External
Elbow |
| D. 6007C-1 Single-Gang Device Plate | J. 6017TX Inverted to External Elbow |
| E. 6007C-2 Two-Gang Device Plate | K. 6046KD Circuit Breaker Housing |
| F. 6010B Blank End Fitting | |

COLOR OPTIONS



6000® Series Raceway Part Numbers with a "V" prefix have an ivory finish. Part Numbers with a "G" prefix have a gray finish.

Custom color options are also available. Consult the factory for more information.

6000[®] SERIES RACEWAY

6000 Series Raceway Ordering Information (continued)

V6074A, G6074A Take-Off Connector (6000-4000)

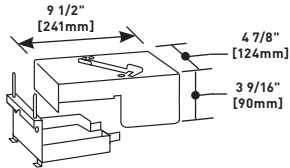

For 90° tee connection at any point along a run of 6000 Series Raceway.

V6086, G6086 Panel Connector Fitting

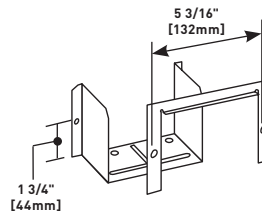

For connecting 6000 Series Raceway with surface type panel boxes. Accommodates maximum wire capacity of 6000 system. Separate C-flange fits around raceway, covering any irregularities made when cutting into box. Cut 4 3/4" x 3 9/16" [121mm x 90mm] hole in panel box.

6000 Series Interconnectivity Fittings

CONNECTION REQUIRED		USE CATALOG NUMBER
FROM	TO	
6000 Series Raceway	4000 (Tee Connection)	G6074A
6000 Series Raceway	6000 (Tee Connection)	G6074
1/2", 3/4", 1" or 1 1/4" trade size Conduit or Armored Cable	Cover of 6000	G4046H-2
1 1/4", 1 1/2", or 2" trade size Conduit or Armored Cable	Back and/or Side of 6000	G6014A

6000 Series Raceway Installation Details

- Determine method of feeding raceway:** 6014A for backfeed, 6086 (shown) for panel feed.

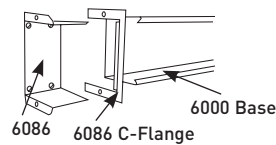

- To mount 6000 Base to surface:** Remove mounting screw KOs (approx. 18" [457mm] O.C. along base) as required. Mount base with No. 8 flathead fasteners.

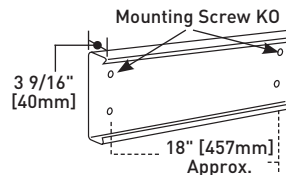

- To join lengths of 6000B, insert the pair of 6001A Couplings into one side of each base. Slide bases together and tighten locking screws.

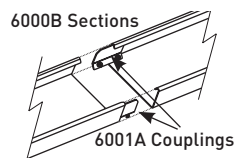

- For divided installations:** Install G6001DA Divider Clips at 30" [762mm] intervals. Snap G6000DA Divider into place.

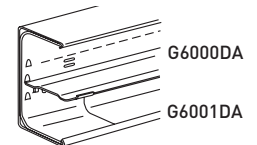

- To install G6007C-1 or G6007C-2 Device Plates:** Snap into base and tighten clamps as shown. Wire device and assemble to bracket. Install flush plate (not furnished).

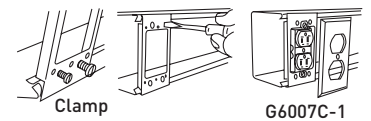

- Cut 6000C Cover to fit between device brackets. Snap in place as shown. Continue along entire run.

